



24/7
DEFEND™
Solutions for Healthier,
Safer Spaces

CONTAIN CLEAN PROTECT

CLEAN ROOM™

15/16" Exposed Tee Suspension System
steel

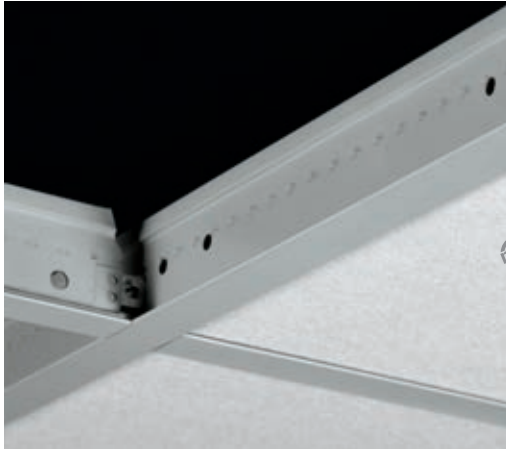

This suspension system with integral gasket is designed specifically for clean rooms, food processing areas, and data centers.

KEY SELECTION ATTRIBUTES

- Suitable for use in Class 5 (Class 100 clean rooms as defined by ISO Standard 14644-1 (Federal Standard 209E) when used with Clean Room™ FL, Clean Room VL, Health Zone™ Ultima®, and Health Zone™ Optima®
- CleanAssure™ family of products – includes disinfectable panels, suspension systems, and trim (Cleaning and CDC approved disinfecting options available on armstrongceilings.com/cleaning)
- Seismic Rx® Suspension System; ICC-ES approach to installations (ESR-1308)
- Integral gasket for better seal between panel and grid
- Integral main beam splice for easy connections and module control
- XL® staked-on end detail
- Rotary-stitched for additional torsion strength
- 10-year limited warranty; 30-year with HumiGuard® Plus

TYPICAL APPLICATIONS

- Laboratories
- Pharmaceutical facilities
- Automotive and aerospace
- Computer rooms
- Hospitals
- Food processing facilities
- High-tech manufacturing
- Data Centers

COLOR



▲ Clean Room™ suspension system

VISUAL SELECTION Aluminum – maximum corrosion resistance

Item No.	Description	Rout Spacing	Dimensions (Inches)	HANGER SPACING* LBS./LFT			Fire Guard™	Seismic Category	PACKAGING	
				2 Ft.	4 Ft.	5 Ft.			Pieces/ Carton	LFT/ Carton
CLEAN ROOM Co-Extruded Aluminum (Gasketed) 15/16"	ES7901	12' HD Main Beam	12" O.C.	144 x 15/16 x 1-11/16"	N/A	18.33	N/A	•	20	240
	ES7940	4' Cross Tee	24" O.C.	48 x 15/16 x 1-11/16"	N/A	16.83	N/A	N/A	60	240
	ES7920	2' Cross Tee	N/A	24 x 15/16 x 1-11/16"	60.83	N/A	N/A	N/A	60	120
	ES7801	12' Hemmed Angle Molding		144 x 15/16 x 15/16"	N/A	N/A	N/A	N/A	30	360
Other Sizes	Main beams L: 36" - 144" / Cross tees L: 24" - 144" / Rout spacing 6" from ends, 12" thereafter								Varies	Varies

Dots represent high level of performance.

ACCESSORIES

CHDC – Clear Hold Down Clip
Attaches to top bulb of the suspension system to hold 1/16" to 5/8" lay-in panel in place; helps to prevent ceiling panel fluttering at entryways.



CHDC – 50 pcs
FZCHDC – 50 pcs

XTAC – Cross Tee Adapter Clip
Attaches cross tees or main beams to the structural wall molding when supporting heavy loads around the perimeter of the ceiling installation.

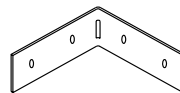

XTAC – 100 pcs
FZXTAC – 50 pcs

BERC2 – 2" Beam End Retaining Clip
Allows you to create a code compliant Seismic D, E, F ceiling installation while eliminating the need to use 2" wall molding or spreader bars.

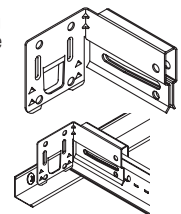

BERC2 (Steel) – 200 pcs
FZBERC2 (Steel) – 50 pcs

CLEAN ROOM™

15/16" Exposed Tee Suspension System

steel



LEED® WELL™ LBC

UP TO **30% RECYCLED CONTENT**

- energy management
- construction waste mgmt
- regional materials
- design for flexibility
- ALUMI-NUM
- EPD
- recyclable/producer resp.
- biobased materials
- recycled content
- sourcing of raw materials
- material ingredient reporting
- low emitting materials
- lighting quality
- acoustics

LOCATION DEPENDENT

Well Building Standard™ (WELL) Living Building Challenge® (LBC)

MAXIMUM FIXTURE WEIGHT

Item No.	CONFIGURATION		FIXTURE*		PLANNING MODULE		HANGER SPACING		MAXIMUM WEIGHT	
	A	B	A	B	A	B	A	B	A	B
Main Beam to Main Beam ES7901			24" x 48"	N/A	48" x 48"	N/A	48"	N/A	100.0 lbs.	N/A
			24" x 48"	12" x 48"	48" x 48"	48" x 48"	48"	48"	70.0 lbs.	100.0 lbs.
			12" x 48"	N/A	48" x 48"	N/A	48"	N/A	69.0 lbs.	N/A

* Fixtures weighing more than 56 lbs. should be independently supported. Fixture weight is based on single fixture only. For end-to-end fixtures or other configurations not shown, consult your Armstrong representative..

DETAILS

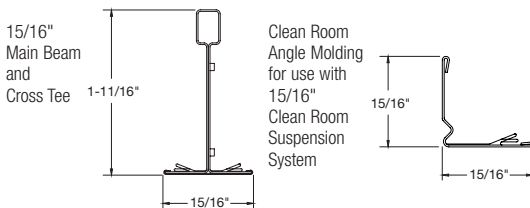

SEISMIC PERFORMANCE

Main Beams – Minimum Lbs. To Pull Out Compression/Tension
ES7901 - 294.6

Cross Tees – Minimum Lbs. To Pull Out Compression/Tension
ES7940, ES7920 - 492.40

ICC Reports
For areas under ICC jurisdiction, see ICC evaluation report number 1308 for allowable values and/or conditions of use concerning the suspension system components listed on this page. The report is subject to reexamination, revisions, and possible cancellation.

PHYSICAL DATA

Material
Hot-Dipped Galvanized – Gasketed

Surface Finish
Baked Polyester Paint

Manufactured and tested in accordance with ASTM C635

Cross Tee/Main Beam Interface
Flush Fit

End Detail
Main Beam: Integral Hook
Cross Tee: Staked-on Clip