

PRELUDE® XL® MAX™

Exposed Tee System



SUSTAIN™
High Performance
Sustainable
Ceiling Systems

Declare.

UP TO **25%** RECYCLED CONTENT

Calculate LEED contribution at armstrong.com/greengenie

LEED® icons for: energy management, construction waste mgmt, regional materials, design for flexibility, EPD, recyclable/extended producer resp., biobased materials, recycled content, sourcing of raw materials, material ingredient reporting, low emitting materials, lighting quality, acoustics.

LOCATION DEPENDENT



Prelude® XL® Max™ with Ultima® item 1927 ceiling panels

KEY SELECTION ATTRIBUTES

Prelude XL Max 15/16" Suspension System

- 2' x 2' and 2' x 4' suspension system supports point loads up to 300 lbs. using 3/8" threaded rod and integrated hanging clips to provide:
 - Flexible and reconfigurable overhead cable tray and electrical distribution to meet client needs without a separate strut channel system
 - Eliminates unsightly threaded rod penetrations through the ceiling plane for improved access and aesthetics
 - Reduced ceiling penetrations help minimize unwanted air infiltration
- Suspension system meets ASTM C635, ASTM C636, ASTM E580, ICC-ES AC156 with Seismic D, E, F available
- 30-Year Limited System Warranty
- Standard 2' x 2' and 2' x 4' grid layouts allow for use of standard size lighting and specially sized Prelude XL Max ceiling tile options

TYPICAL APPLICATIONS

- Data Centers
- Laboratories
- Hospitals

For custom layout information and technical guidelines, contact TechLine customer support at 877 276-7876.

These panels are specially sized and engineered for Prelude® XL® Max™ and must be used with the system. These panels do not fit in other suspension systems.

VISUAL SELECTION

PERFORMANCE

PACKAGING

Item No.	Face Profile	Description	Dimensions (Inches)	Max Loading**		Fire Guard™	Seismic Category	Pcs./ Ctn.	Lin. Ft./ Ctn.
				Lbs./Lin. Ft.					
Prelude XL Max				4 Ft.	2 Ft.	Dots represent high level of performance.			
<input type="checkbox"/> 730145	15/16"	12' HD Main Beam	144 x 15/16 x 2.44"	40.17	135.5	–	•	10	120
<input type="checkbox"/> XL7345	15/16"	4' Cross Tee	48 x 15/16 x 2.44"	40.17	–	–	•	30	120
<input type="checkbox"/> XL7325	15/16"	2' Cross Tee	24 x 15/16 x 2.44"	–	93.82	–	•	30	60
Molding									
<input type="checkbox"/> SWA9878HRC	7/8"	12' Structural Wall Angle	144 x 7/8 x 7/8"	–	–	–	•	12	144

** Simple Span







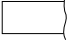

PRELUDE® XL® MAX™

Exposed Tee System

These panels are specially sized and engineered for Prelude XL Max and must be used with the system. These panels do not fit in other suspension systems.

VISUAL SELECTION

PERFORMANCE SELECTION Dots represent high level of performance.

Edge Profile	Item No.	Description	Dimensions Nominal (Inches)	UL Classified Acoustics		Total Acoustics ¹	Fire Performance	Light Reflect	Anti-Mold & Mildew	Sag Resist	Certified Low VOC Emissions	Durability	Recycled Content	Recycle Program	30-Yr Warranty	
				NRC	CAC											
PRELUDE® XL® MAX™ Square Lay-in																
	1778	Fine Fissured	23.5 x 23.5 x 5/8"	0.75	35	BETTER 	170	Class A	0.86	•	•	•	Std	•	•	•
	1779	Fine Fissured	23.5 x 47.5 x 5/8"	0.75	35	BETTER 	170	Class A	0.86	•	Std	•	Std	•	•	1-Yr
	1488	Canyon	23.5 x 23.5 x 5/8"	0.60	35	GOOD 	170	Class A	0.80	•	•	•	Std	Std	•	•
	1489	Canyon	23.5 x 47.5 x 5/8"	0.60	35	GOOD 	170	Class A	0.80	•	•	•	Std	Std	•	•
	1927	Ultima	23.5 x 23.5 x 3/4"	0.80	35	BEST 	170	Class A	0.87	•	•	•	•	•	•	•
	1928	Ultima	23.5 x 47.5 x 3/4"	0.80	35	BEST 	170	Class A	0.87	•	•	•	•	•	•	•
	1815	Clean Room FL	23.5 x 23.5 x 3/4"	0.55	35	–	–	Class A	0.79	•	•	•	•	•	–	•
	1816	Clean Room FL	23.5 x 47.5 x 3/4"	0.55	35	–	–	Class A	0.79	•	•	•	•	•	–	•
	3398	Optima	23.5 x 23.5 x 1"	0.90	N/A	–	200	Class A	0.90	•	•	–	•	•	–	•
	3399	Optima	23.5 x 47.5 x 1"	0.90	N/A	–	180	Class A	0.90	•	•	–	•	•	•	•
	1747ABL	Fine Fissured – Black	23.5 x 23.5 x 5/8"	0.75	35	BETTER 	170	Class A	0.86	•	•	•	Std	•	•	•
	1748ABL	Fine Fissured – Black	23.5 x 47.5 x 5/8"	0.75	35	BETTER 	170	Class A	0.86	•	Std	•	Std	•	•	1-Yr

* These panels are specially sized and engineered for Prelude XL Max and must be used with the system. These panels do not fit in other suspension systems.

ACCESSORIES

PMHC – Prelude Max Hanging Clip – Used to carry the ceiling system with 3/8" threaded rod from structure.

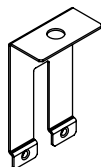

* Machine screws, Heavy Hex Nut, and Locknut included

- PMHC – 150 pcs
- FZPMHC – 50 pcs

PMLC – Prelude XL Max Load Connector – Used to support bus bars, cable trays, hot aisle containment, and other components with 3/8" threaded rod from the suspension system face.

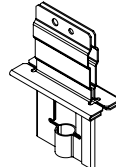

* Heavy Hex Nut & Locknut included

- PMLC – 100 pcs
- FZPMLC – 50 pcs

IJC – Intersection Joint Clip – Used to connect all cross tees together for rigid connection.

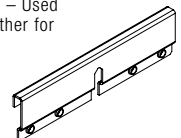

* Machine screws included

- IJC – 250 pcs
- FZIJC – 50 pcs

XTAC – Cross Tee Adapter Clip – Securely attaches cross tees or main beams to the structural wall molding around the perimeter of the ceiling installation.

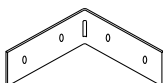

- XTAC – 100 pcs
- FZXTAC – 50 pcs

TLMBS – Top Lock Main Beam Splice Clip – Locks two main beams together for a secure connection.

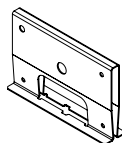

PMHDC – Maximum Hold Down Clip – Attaches to the top bulb of the Prelude XL Max suspension system to hold ceiling panels in place; helps to prevent ceiling panel movement.

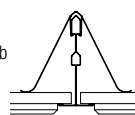

- PMHDC – 100 pcs
- FZPMHDC – 50 pcs

LSB – Lateral Support Bar

* Seismic Zone DEF Only

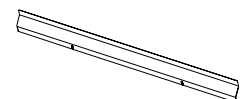

- LSB12HRC – 10 pcs/120 LF
- LSB10HRC – 10 pcs/100 LF
- LSB8HRC – 10 pcs/80 LF

