

METALWORKS™ Blades – Classics™

Linear Panels with Acoustical Options
smooth texture

CAD/Revit® drawings at:
armstrongceilings.com

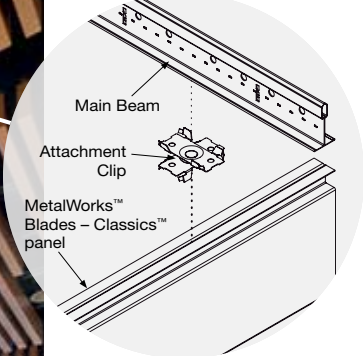

plus capabilities
to do more

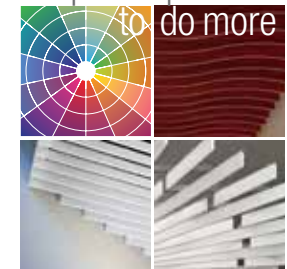

armstrongceilings.com/capabilities
See more photos at:
armstrongceilings.com/photogallery

MetalWorks™ Blades – Classics™ in 48" and 96" lengths in Effects™ Cherry.

Durable metal vertical panels in upscale linear designs are available in acoustical or non-acoustical options.

KEY SELECTION ATTRIBUTES

- new • New standard blade sizes in multiple lengths with either:
 - 4" depth and 1" width
 - 6" depth with 1" or 2" widths
- new • Custom blade options (1" or 2" wide):
 - Length: 12" – 120"
 - Depth: 4" – 12"
- Available in 22 1/2", 46 1/2", 94 1/2", and 96" lengths for creative design layouts
- Blade panels available with either two factory-installed end caps, one end cap, or no end caps
- MetalWorks™ Blades – Classics™ panels are part of the Sustain™ portfolio (unperforated panels only)
- Now able to cut panels at the job site – use Field Cut End Cap for a clean finish
- Available in six Effects™ Wood Looks finishes
- Excellent acoustical performance; up to 4.20 Sabins per panel
- Create acoustical or non-acoustical upscale linear designs
- Blades panel spacing is variable to accommodate a variety of design and acoustical needs
- Fast, easy installation with standard Prelude® XL® 15/16" or 360° painted suspension systems



Field Cut End Cap shown inserted and uninstalled.

COLORS

Due to printing limitations, shade may vary from actual product.

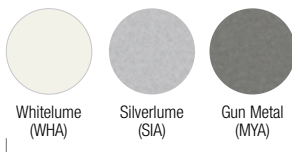

Part of the Sustain™ portfolio, meeting sustainability compliance standards (M1 – unperforated panels only)



PERFORATION OPTIONS

(1:2 scale shown)

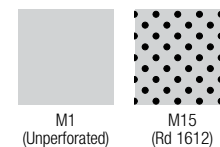

Additional sizes and colors may be available. For more information contact Architectural Specialties TechLine at 1 877 276-7876 or ASQuote@armstrongceilings.com for a quote.



UP TO 80% RECYCLED CONTENT

For LEED contribution contact TechLine

METALWORKS™ Blades – Classics™

Linear Panels with Acoustical Options
smooth texture

Declare.

SUSTAIN™
High Performance
Sustainable
Ceiling Systems
Unperforated (M1)

LEED®	energy management	construction waste to right	regional materials	design for flexibility	EPD	recyclable/extended producer resp.	low-toxic materials	recycled content	sourcing of raw materials	material ingredient reporting	low emitting materials	lighting quality	acoustics
-------	-------------------	-----------------------------	--------------------	------------------------	-----	------------------------------------	---------------------	------------------	---------------------------	-------------------------------	------------------------	------------------	-----------

VISUAL SELECTION

PERFORMANCE

Edge Profile	Item No. ♦	Description/Dimensions L x W x D (Inches) Custom Sizes Available	
METALWORKS™ Blades – Classics™			
	8157D41 -----	Vertical panel with caps on both ends 94-1/2 x 1 x 4"	
	8157D61 -----	94-1/2 x 1 x 6"	
	8157D62 -----	94-1/2 x 2 x 6"	
	8156D41 -----	Vertical panel with caps on both ends 46-1/2 x 1 x 4"	
	8156D61 -----	46-1/2 x 1 x 6"	
	8156D62 -----	46-1/2 x 2 x 6"	
	8155D41 -----	Vertical panel with caps on both ends 22-1/2 x 1 x 4"	
	8155D61 -----	22-1/2 x 1 x 6"	
	8155D62 -----	22-1/2 x 2 x 6"	
	7202D41 -----	Vertical panel with cap on one end 96 x 1 x 4"	
	7202D61 -----	96 x 1 x 6"	
	7202D62 -----	96 x 2 x 6"	
	7203D41 -----	Vertical panel with no end caps 96 x 1 x 4"	
	7203D61 -----	96 x 1 x 6"	
	7203D62 -----	96 x 2 x 6"	
Custom Blade Panel Options		Length: 12" – 120" Depth: 4" – 12" Width: 1" or 2"	

Sabins per Panel	Durability		
	Wash	Scrub	Soil
2.47	•	•	•
3.35	•	•	•
4.13	•	•	•
1.21	•	•	•
1.65	•	•	•
2.03	•	•	•
0.59	•	•	•
0.80	•	•	•
0.98	•	•	•
2.51	•	•	•
3.40	•	•	•
4.20	•	•	•
2.51	•	•	•
3.40	•	•	•
4.20	•	•	•

- ♦ When specifying or ordering, include the appropriate perforation and color suffix with the item number (e.g., 8157D41 M 1 5 E X M P).
- † With M15 perforation

Dots represent high level of performance.

ACCESSORIES

Item Number	Description	Pieces/Carton
7204 -- ♦♦	MetalWorks™ Blades – Classics™ Attachment Clip (SS – Stainless Steel and KO – Black Oxide)	100
7205D41 7205D61 7205D62	MetalWorks™ Blades – Classics™ 1" x 4" Alignment Device 1" x 6" Alignment Device 2" x 6" Alignment Device	24
8158D41 ----- ♦ 8158D61 ----- 8158D62 -----	MetalWorks™ Blades – Classics™ 1" x 4" Field Cut End Cap 1" x 6" Field Cut End Cap 2" x 6" Field Cut End Cap	10

- ♦ When specifying or ordering, include the color suffix with the item number (e.g., 8158D61 E X M P).
- ♦♦ When specifying or ordering, include the appropriate 2-letter color suffix, SS – Stainless Steel or KO – Black Oxide, (e.g., 7204 S S).

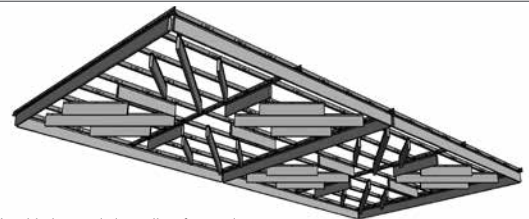

New blade panel sizes allow for maximum design flexibility. See other possible design layouts in our MetalWorks™ Blades design guide.

SUSPENSION SYSTEMS

15/16"

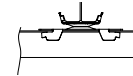

Prelude® XL® suspension system (Black) or 360° Painted Grid

PHYSICAL DATA

Material
Aluminum – thickness 0.032"

Surface Finish
Factory-applied polyester paint. Available in Whitelume, Silverlume, Gun Metal, and Effects™ Wood Looks powder-coated, post-production finishes. Custom colors also available. Contact TechLine for custom color matching requests at 1 877 276-7876.

Fire Performance
Tested per ASTM E84. Flame Spread Index 25 or less. Smoke Developed Index 50 or less.

CAN/ULC S102 surface burning characteristics. Flame Spread Rating 25 or less. Smoke Developed Classification 50 or less.

Acoustical Options

Perforated panels are supplied with a black fiberglass fleece acoustic infill bag to absorb sound (varies by Blades panel length, width, and depth).

Design Support

Project assistance is available by calling TechLine customer support at 1 877 276-7876.

Design Considerations

When installed, panels hang either 4-7/8" or 6-7/8" below grid face. Panels can be supported by intermediate duty main beams or cross tees, with 2 attachment clips per panel. See MetalWorks™ Blades – Classics™ design guide online for additional design layouts.

MetalWorks Blades – Classics can be cut in the field only when using the Field Cut End Cap. See installation instructions for details.

For products with 2 end caps, minimum gap from panel to panel will be 1/4". 96" panels without end caps can be spliced together with Alignment device.

Seismic Restraint

MetalWorks™ Blades – Classics™ are approved for application in all seismic areas when installed per the seismic guidelines in the Armstrong Ceilings installation instructions.

Warranty

Details at armstrongceilings.com

Weight

D41 panels: 0.50 lbs/LF
D61 panels: 0.61 lbs/LF
D62 panels: 0.68 lbs/LF

TechLine / 1 877 276-7876
armstrongceilings.com/blades
(search: metalworks blades-classics)

BPCS-5092-720

LEED® is a trademark of the U.S. Green Building Council
Declare® is a trademark of The International Living Future Institute®
Revit® is a trademark of Autodesk, Inc; all other trademarks used herein are the property of AWI Licensing LLC and/or its affiliates
© 2020 AWI Licensing LLC Printed in the United States of America

Armstrong®
CEILING & WALL SOLUTIONS