



Smooth-textured, hidden acoustical solution that installs direct-to-deck multiple ways while maintaining exposed structure designs and reducing noise.

KEY SELECTION ATTRIBUTES



- Now you can install InvisAcoustics™ panels direct-to-deck multiple ways using:
 - Recommended adhesive
 - Hat channel
 - Furring strips
 - Armstrong® Drywall Grid
- InvisAcoustics panels are part of the Sustain® portfolio and meet the most stringent sustainability compliance standards today (white and field paintable panels only)
- InvisAcoustics Wall installation – 6' from the ground or higher
- Good acoustical absorption – NRC up to 0.75
- USDA Certified Biobased Product, 95%
- Install InvisAcoustics panels on Trusses and I-Beams for added acoustics while maintaining an exposed structure visual on the deck

- Field paintable panels can be sprayed same color as deck
- Smooth, clean durable finish – Scratch-resistant
Soil-resistant
- Panels cut easily to fit into any space
- Foolproof, “all-in-one” fastener allows for easy installation to the wall, deck, or I-beam without the danger of over-driving and damaging the panel

TYPICAL APPLICATIONS

- Exposed structure
- Open plenum offices
- Painted decks
- Drywall spaces requiring acoustical correction
- Retail
- Hospitality

PANEL COLOR* SELECTION

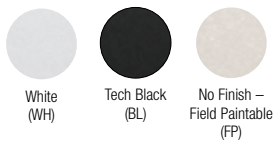

FASTENER COLOR SELECTION

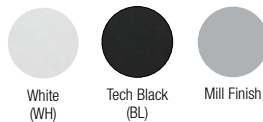

*NOTE: Ceiling Panels are dye-lotted and should be separated by dye lot. Do not mix.

DETAILS (See details online).

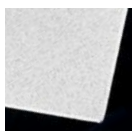

1. InvisAcoustics™ panel



DeclareSM
Living Building
Challenge Compliant
(Excluding 1212BL)

SUSTAINSM
High Performance
Sustainable
Ceiling Systems

UP TO **84%** RECYCLED CONTENT

LEED®

- energy management
- construction waste mgmt
- regional materials
- design for flexibility
- EPD
- recyclable/extended producer resp.
- biobased materials
- recycled content
- sourcing of raw materials
- material ingredient reporting
- low emitting materials
- lighting quality
- acoustics

Calculate LEED contribution at armstrongceilings.com/greengenie

VISUAL SELECTION

Edge Profile	Item No.	Dimensions (Inches)
	1212WH	24 x 48 x 3/4"
	1212BL*	24 x 48 x 3/4"
	1212FP	24 x 48 x 3/4"

¹ Total Acoustics® ceiling panels have an ideal combination of noise reduction and sound-blocking performance in one product.
* Tech Black is not included in the Sustain® portfolio

PERFORMANCE SELECTION Dots represent high level of performance.

	Fire Rating	Light Reflect	Mold & Mildew Protection	Sag Resist	Certified Low VOC Emissions	Wash	Impact	Scratch	Soil	Recycle Program	10-Yr Warranty
Class A	N/A	•	•	•	N/A	•	•	•	•	•	•
Class A	N/A	•	•	•	N/A	•	•	•	•	•	•
Class A	N/A	•	•	•	N/A	•	•	•	•	•	•

ACOUSTICAL INFORMATION

Panel Thickness	NRC	Mounting Method
3/4"	0.75	D-20
3/4"	0.70	A

ACCESSORIES



Wall, Deck, and I-Beam – “All-in-One” self-stopping fastener
Mill Finish (1221)
Colors (1221_)

Fasteners must be ordered separately

100pcs/ctn



Truss Fastening Kit
Mill Finish (1222)
Colors (1222_)

Kit must be ordered separately

20pcs/ctn

ACCESSORIES – BY OTHERS



Recommended Adhesive – Titebond® GREENchoice Acoustical Ceiling Tile Adhesive

INSTALLATION DETAILS

Wall, Deck, or I-Beam



InvisAcoustics™ Field Paintable 24" x 48" Panels

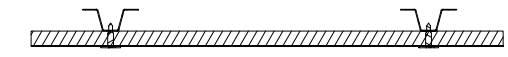

Wall, deck, or I-beam installation using hat channel /furring (D-20 mounting)

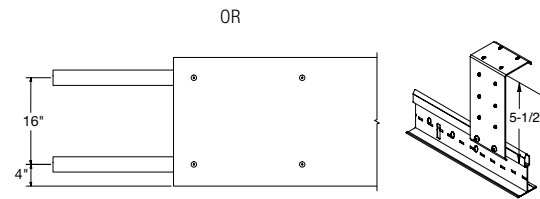

Wall, deck, or I-beam installation using Armstrong® Drywall Grid and uptight clips

NOTE: Installation with Armstrong Drywall Grid and uptight clips allows for a drop of up to 5-1/2" to get around obstructions.

NOTE: For more details, refer to installation instructions at armstrongceilings.com/invisacoustics



INSTALLATION DETAILS

new Direct-Apply



InvisAcoustics™ Direct-Apply Panels in White

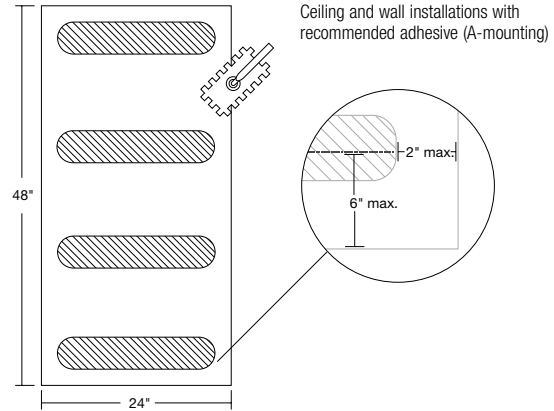

I-Beam



InvisAcoustics™ Panels in Black

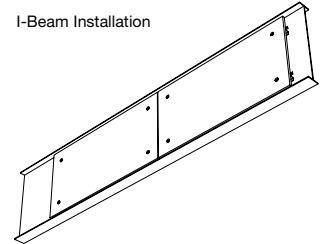
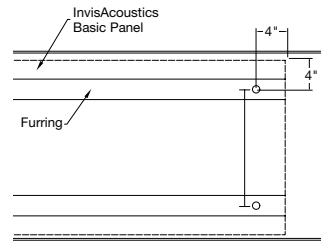

Truss

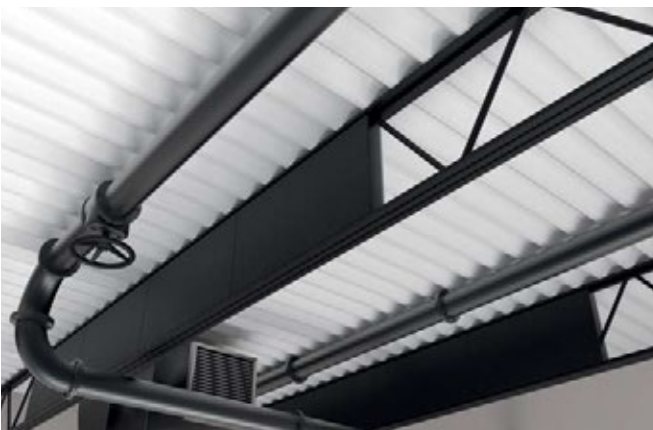

InvisAcoustics™ Panels in Black Truss Installation

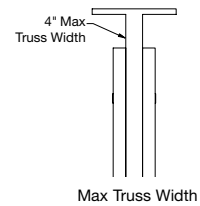
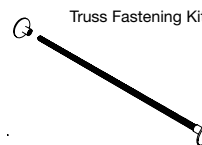
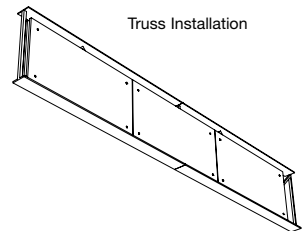
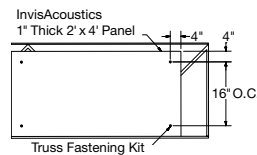

NOTE: For more details, refer to installation instructions at armstrongceilings.com/invisacoustics

EXPOSED STRUCTURE – DIRECT-TO-DECK

UP TO **84%** RECYCLED CONTENT

Calculate LEED contribution at armstrongceilings.com/greengenie

LEED®	energy management	construction waste mgmt	regional materials	design for flexibility	EPD	recyclable/extended producer resp.	biobased materials	recycled content	sourcing of raw materials	material ingredient reporting	low emitting materials	lighting quality	acoustics
-------	-------------------	-------------------------	--------------------	------------------------	-----	------------------------------------	--------------------	------------------	---------------------------	-------------------------------	------------------------	------------------	-----------

LOCATION DEPENDENT



PHYSICAL DATA

Material

Wet-formed mineral fiber

Surface Finish

Factory-applied latex paint (Items 1212WH, 1212BL)
Factory-applied scrim (Item 1212FP)

Fire Performance

ASTM E84 and CAN/ULC S102 surface burning characteristics. Flame Spread Index 25 or less. Smoke Developed Index 50 or less (UL labeled except field painted panels.)

ASTM E1264 Classification

Type IV, Form 2, Pattern E
Fire Class A

Humidity/Sag Resistance

HumiGuard® Plus ceiling panels are recommended for areas subject to high humidity, up to, but not including, standing water and outdoor applications.

Mold/Mildew Protection

Factory-finished panels offer BioBlock® performance and resist the growth of mold and mildew. Mold/mildew performance of unpainted/field painted panels is determined by the type of paint used.

High Recycled Content

Contains greater than 50% total recycled content. Total recycled content based on product composition of post-consumer and pre-consumer (post-industrial) recycled content per FTC guidelines.

Field Painting Considerations

Recommend Sherwin-Williams® Waterborne Acrylic Dry Fall (B42W1) or substitute Alkali based, flat latex paint with similar properties. Field painting may alter acoustical and fire performance.

Recommended Spread Rate per Coat:

Wet Mils: 3.5-5.0
Dry Mils: 1.5-2.0

Installation Considerations

Install using all-in-one screw (1221) on furring. Panels can be butted short edge to short edge or long edge to long edge. Due to directionality, do not butt short edge to long edge. Factory Painted ceiling panels are dye-lotted and should be separated by dye lot. Do not mix. It is recommended to install wall panels at least 6' above finished floor to avoid contact. Avoid applying direct-apply panels to a newly painted ceiling. Glossy painted surfaces must be abraded. For painted or sealed surfaces, install a small test area and observe after 12 hours. For plaster ceilings, plaster must be painted, non-chipping, and smooth.

Design Considerations

Factory painted product have short edges that are reverse regular; butting the boards 24" edge to 24" edge will show a notch that will appear to be a 0.450" x 0.385" cutout.

Acoustical Performance

0.75 NRC is the acoustical value for D-20 mounting. When using A mounting method for panels, NRC is reduced to 0.70.

Insulation Value

R Factor – 3.2 (BTU Units)
R Factor – 2.9 (Watts Units)

10-Year Warranty

System warranty when installed with Armstrong® suspension systems and accessories. Direct-Apply installations have a 10-year panel warranty. Details at armstrongceilings.com/invisacoustics.

Weight; Square Feet/Carton

1212WH, 1212BL, 1212FP – 1.08lbs/SF; 48 SF/ctn

Minimum Order Quantity

1 carton

LEED® is a registered trademark of the U.S. Green Building Council.
Declare™ is a service mark of The International Living Future Institute.
Titebond® is a registered trademark of Franklin International.
Sherwin-Williams® is a registered trademark of The Sherwin-Williams Company.
UL is a registered trademark of UL LLC. All other trademarks used herein are the property of AWI Licensing LLC and/or its affiliates.
© 2020 AWI Licensing LLC Printed in the United States of America