

TECTUM® Shapes

Acoustical Clouds
coarse texture



Tectum Shapes panels suspended application – 2" thick

CAD/Revit® drawings at:
armstrongceilings.com/cadrevit

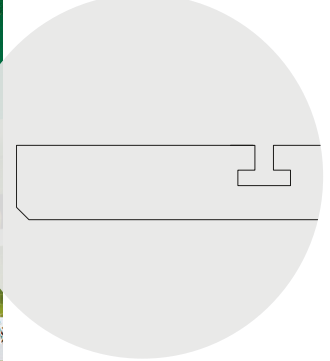

Tectum® Shapes deliver design flexibility and acoustical performance in a suspended or direct-attach system formats.

KEY SELECTION ATTRIBUTES

- Shapes are available in suspended or direct attach formats for maximum design flexibility
- Tectum panels are part of the Sustain® portfolio and meet the most stringent industry sustainability compliance standards today
- CleanAssure™ family of products – includes disinfectable panels, suspension systems, and trim (standard colors only)
- Mold- and mildew-resistant surface
- Available in 1", 1-1/2", and 2" panel thickness in premium and custom shapes
- Direct-attach shape panels can be mechanically fastened to a wide variety of surfaces including masonry, drywall, wood, and more
- 1-1/2" and 2" suspended shapes install with 15/16" Prelude® Suspension System
- Seismic DEF approved
- Can be field painted up to 6 times without impacting acoustic or fire performance
- USDA-Certified Biobased Product 98% (preferred for government projects)
- Made in the U.S.A. of domestic and global content
- Build America, Buy America (BABA) Act compliant

TECTUM® Shapes

Acoustical Clouds
coarse texture

USDA
CERTIFIED
BIOBASED
PRODUCT
PRODUCT 95%



LEED V5

COMMON MATERIALS FRAMEWORK		Climate Health	EPD
Human Health	Declare Label	Ecosystem Health	EPD
	HPD		FSC
	3rd Party CDPH	Circular Economy	✓
OCCUPANT EXPERIENCE		Acoustics	✓

TECTUM DESIGN CAPABILITIES

COLORS Due to printing limitations, shade may vary from actual product.

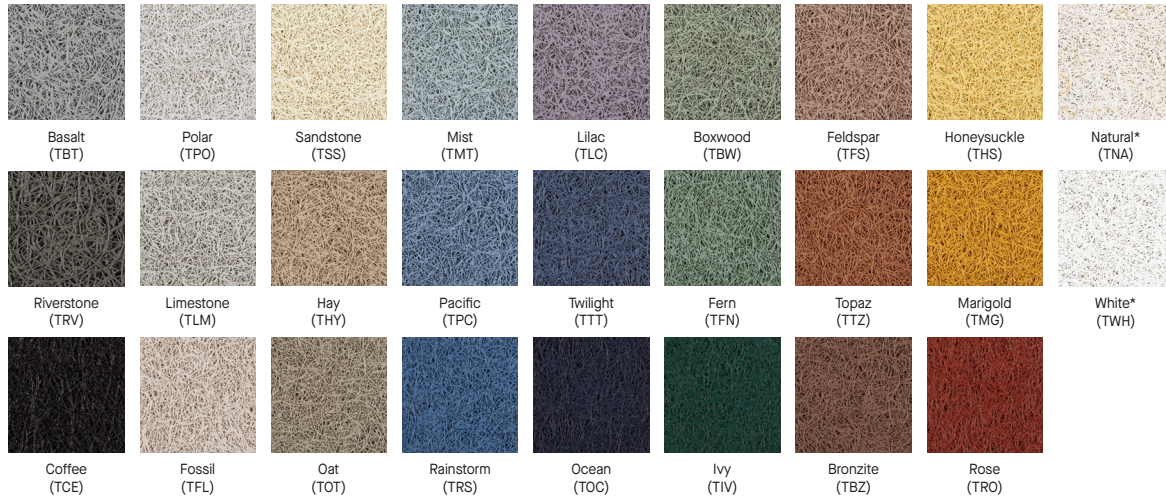

Custom Colors
Available**

* Standard color options; Nature-inspired colors are premium.
All colors shown are pre-qualified to meet Sustain® portfolio requirements.

** Custom, made-to-order colors must be evaluated if sustainability criteria is required. Lead time will increase.
Contact ASQuote@armstrongceilings.com

DIRECT-ATTACH DETAILS

Mounting A

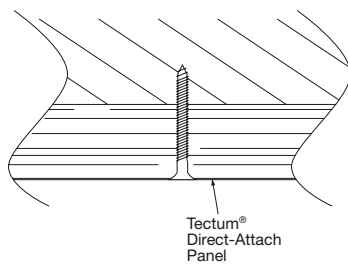

Mounting D-20

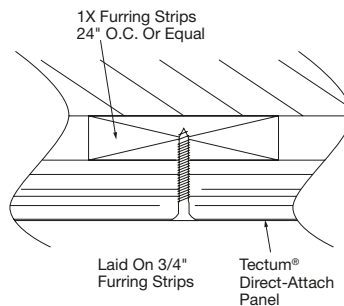

Mounting C-20

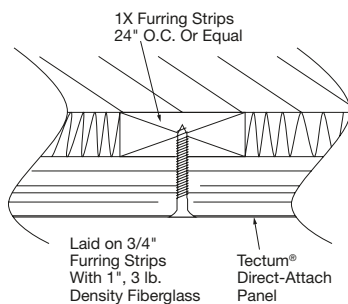

Mounting C-40

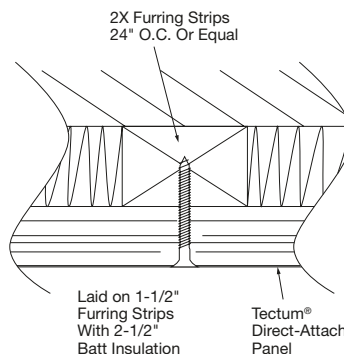

SUSPENDED DETAILS

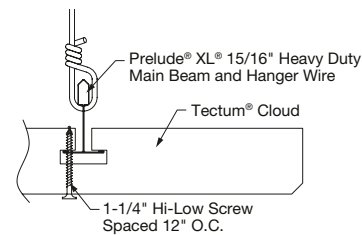

TECTUM® Shapes

Acoustical Clouds
coarse texture

USDA
CERTIFIED
BIOBASED
PRODUCT
PRODUCT 95%



SUSTAIN®
High Performance
Sustainable Ceiling Systems

Declare.

LEED V5

COMMON MATERIALS FRAMEWORK		
Climate Health	EPD	
Human Health	Declare Label	
	HPD	
	3rd Party CDPH	
OCCUPANT EXPERIENCE		
Acoustics		

VISUAL SELECTION

PERFORMANCE SELECTION

Dots represent high level of performance.

ACOUSTICAL INFORMATION

TECTUM® Shapes	Panel Thickness	Panel Shape	Dimensions W x L x D (Inches)	Colors	Fire Rating	Light Reflect (White only)	Anti-Mold/Mildew	Humi-Guard+	Sag Resist	Certified Low VOC Emissions	CleanAssure™ Disinfectable Panels	Fog	Impact	Scratch*	30-Yr Warranty	Panel Thickness	Sound Absorption (Sabins/SF)	Mounting Method
TECTUM® Shapes	1" 1-1/2" 2"	Rounded Square	46 x 46 x 1" 46 x 46 x 1-1/2" 46 x 46 x 2"	TNA, TWH, Custom	Class A	Up to 0.75	*	*	*	*	*	*	*	*	*	1"	0.40	A
	1" 1-1/2" 2"	Square	46 x 46 x 1" 46 x 46 x 1-1/2" 46 x 46 x 2"	TNA, TWH, Custom	Class A	Up to 0.75	*	*	*	*	*	*	*	*	*		0.45	D-20
	1" 1-1/2" 2"	Circle	46 x 46 x 1" 46 x 46 x 1-1/2" 46 x 46 x 2"	TNA, TWH, Custom	Class A	Up to 0.75	*	*	*	*	*	*	*	*	*	1-1/2"	0.55	A
	1" 1-1/2" 2"	Concave Square	41 x 46 x 1" 41 x 46 x 1-1/2" 41 x 46 x 2"	TNA, TWH, Custom	Class A	Up to 0.75	*	*	*	*	*	*	*	*	*		0.60	D-20
	1" 1-1/2" 2"	Convex Square	43-1/2 x 46 x 1" 43-1/2 x 46 x 1-1/2" 43-1/2 x 46 x 2"	TNA, TWH, Custom	Class A	Up to 0.75	*	*	*	*	*	*	*	*	*		0.90	C-20
	1" 1-1/2" 2"	Hexagon	46 x 40 x 1" 46 x 40 x 1-1/2" 46 x 40 x 2"	TNA, TWH, Custom	Class A	Up to 0.75	*	*	*	*	*	*	*	*	*		0.95	C-40
	1" 1-1/2" 2"	Right Parallelogram	46 x 46 x 1" 46 x 46 x 1-1/2" 46 x 46 x 2"	TNA, TWH, Custom	Class A	Up to 0.75	*	*	*	*	*	*	*	*	*	2"	0.60	A
	1" 1-1/2" 2"	Trapezoid	46 x 46 x 1" 46 x 46 x 1-1/2" 46 x 46 x 2"	TNA, TWH, Custom	Class A	Up to 0.75	*	*	*	*	*	*	*	*	*		0.70	D-20

◆ When specifying or ordering, include the appropriate 3-digit color suffix TNA = Natural (unpainted), TWH = White
* Scratch-resistance is applicable to Natural and White panels only.
For special sizes, and colors, contact ASQuote@armstrongceilings.com.

PANEL SHAPE OPTIONS

1-1/2" and 2" thick panels available with or without T-Slot for suspended cloud application – please specify when ordering.

Description/Dimensions (Inches)

Square – 6" Radius cut corner 46" x 46" (Nominal)		Square 46" x 46" (Nominal)		Circle 46" Diameter (Nominal)		Concave 41" x 46" (Nominal)	
Convex 43-1/2" x 46" (Nominal)		Hexagon 46" x 40" (Nominal)		Right Parallelogram 46" x 46" (Nominal)		Trapezoid 46" x 46" (Nominal)	

TECTUM® Shapes

Acoustical Clouds

coarse texture

USDA
CERTIFIED
BIOBASED
PRODUCT
PRODUCT 95%



LEED V5		
COMMON MATERIALS FRAMEWORK		
Human Health	Declare Label	Climate Health
	HPD	Ecosystem Health
	3rd Party CDPH	Circular Economy
OCCUPANT EXPERIENCE		Acoustics
		EPD
		EPD
		FSC
		✓
		✓

CUSTOM SHAPES



Tectum Custom Shapes

CUSTOM SHAPES

Create your own shapes!

For assistance, call TechLine at 877 276-7876.

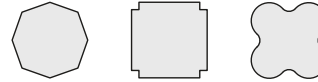

Widths: 23-3/4 to 48"
Lengths: 23-3/4 to 96"
Thickness: 1", 1-1/2", 2"

PHYSICAL DATA

Material

FSC® Certified
Cementitious Wood Fiber; FSC® certified. For more information about FSC® certified fire-retardant products, or to view our FSC® certification letter, contact TechLine at 877 276-7876.

Surface Finish

Factory-applied latex paint with Silicate surface coating for abuse resistance. Natural is unpainted.

Fire Performance

Class A. Flame Spread Index 25 or less and Smoke Developed Index 50 or less when tested in accordance with ASTM E84.

CAN/ULC S102 surface burning characteristics. Flame Spread Index of 25 or less and Smoke Developed Index of 50 or less.

VOC Emissions

Third-party certified compliant with California Department of Public Health CDPH/EHLB/Standard Method Version 1.2, 2017. This standard is the guideline for low emissions in LEED®, WELL™ Building Challenge, CalGreen Title 24, ANSI/ASHRAE/USGBC/IES Standard 189; ANSI/GBI Green Building Assessment Protocol.

Humidity/Sag Resistance

HumiGuard® Plus performance panels are recommended for areas subject to high humidity, up to, but not including, standing water and outdoor applications.

Anti-Mold/Mildew

Ceiling tiles with BioBlock® performance resist the growth of mold and mildew on the tile surface.

Installation Considerations

Use caution and wear appropriate hand, eye, and dust mask protection when cutting and installing Tectum® panels. Refer to installation instructions for complete details and cutting recommendations. Beveled edges on all sides should be specified on all adjoining panel installations.

Primary (Embodied) Energy

See all LCA information on our EPDs.

Application Considerations

Color variation among panels is common due to the natural characteristics of the wood.

Wood fibers may appear orange on Natural colored panels due to the characteristics of the wood.

Low angle lighting exaggerates variation inherent to the manufacturing process and is not recommended for Tectum installations.

Design Considerations

Tectum Shapes are inherently directional due to manufacturing constraints. The finished visual on the front and back of the panel will not match exactly. 360 degree factory or field painting is recommended for all installations.

Design & Pre-Construction Service

For complimentary design and pre-construction assistance, contact ProjectWorks® or visit armstrongceilings.com/projectworks

Cleaning and Disinfecting

Cleaning and CDC-approved disinfecting options available on armstrongceilings.com/cleaning

Warranty

30-Year Warranty. Details at armstrongceilings.com/warranty

Weight

1" – 1.63 LBS/SF
1-1/2" – 2.55 LBS/SF
2" – 3.50 LBS/SF

