

# SKYLO™ – 5" Flat

## Walkable Suspension System



Skylo 5" Flat Walkable Suspension System

Skylo™ Walkable Ceiling Solutions are engineered for performance and constructability, delivering an efficient cleanroom ceiling solution that enables safe, convenient access to overhead equipment without compromising the controlled environment below.

### KEY SELECTION ATTRIBUTES

- Skylo Walkable Ceiling Solutions are the market's only complete grid and panel system with load capacity data tested under ASTM E72
- Ideal combination of a finished ceiling system with a structural solution
- T-bar main beam progressive system, that seamlessly integrates with IMP panels to control humidity and pressures
- Grid and panel system suitable for use in ISO Class 3-5 per ISO Standard 14644-1
- Tested and certified system capable of carrying 20-40 lbs/sq ft of live loads
- Seamless integration with 80, 100, or 120mm thick IMP panels
- Flexible design with 12' or 20' main beam lengths
- Tailored to the specific needs of controlled environments

### TYPICAL APPLICATIONS

- Biotechnology
- Cold storage
- Data centers
- EV Battery
- Life sciences
- Pharmaceutical
- Semiconductor

**COLORS** Due to printing limitations, shade may vary from actual product.

#### Standard

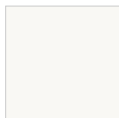

White  
(WH)

White is standard color for main beams and cross tees. All brackets and hardware are unfinished.



# SKYLO™ – 5" Flat

## Walkable Suspension System



Declare.

RECYCLED CONTENT

UP TO 50%

LEED V5

Ecomedes Data

COMMON MATERIALS FRAMEWORK

Human Health	Declare Label	Climate Health	EPD
	HPD	Ecosystem Health	EPD
	3 <sup>rd</sup> Party CDPH	Circular Economy	✓

Well Building Standard™ (WELL)  
Living Building Challenge® (LBC)

### VISUAL SELECTION

### PACKAGING

Item No.	Description	Dimensions (Inches) L x W x H	PCS/ CTN	LF/ CTN
SKY5301	Main Beam	144 x 5 x 2-13/16"	10	120
SKY5302P	Perforated Main Beam	240 x 5 x 2-13/16"	10	200
7800	Perimeter Molding	144 x 7/8 x 7/8"	30	360

NOTE: SKY5302P includes 1/8" holes every 12" on-center on grid face.

### ACCESSORIES

SKY53BC – 5" Face Flat Beam Connector Assembly – Used to connect intersecting beams

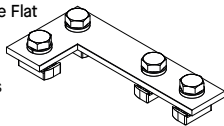

SKY53BC – 12 PCS

SKY53SP – 5" Flat Splice Plate Assembly – Used to splice beam ends

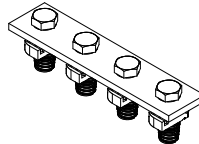

SKY53SP – 24 PCS

SKY5HWK – Skylo Plenum Cap Hardware Kit 2 – Turnbuckles and threaded rods are used for structural support for the beams



SKY5HWK – 12 PCS

SKY53HWK2 – Skylo Hardware Kit 2 – Hanging plate, bolt, and channel nut with spring used to fasten to the beam

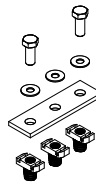

SKY53HWK2 – 24 PCS

SKY5TCP – 5" Face Flat/5" Plenum Cap Top Plate Cover – Used to connect panels over the beam

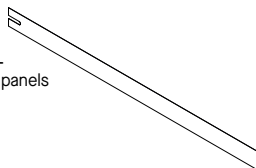

SKY5TCP – 48 PCS

### OPTIONAL COVING ACCESSORIES

SKYCOVB – Cove L Support – Used to provide support to the corner cove

SKYCOV – PVC Coving 3.2M – Used to eliminate sharp corners and edges, providing a smooth transition that is easily cleanable

SKYCS – Internal Corner Cove – Used to close the gap between covings at the corners

### DETAILS

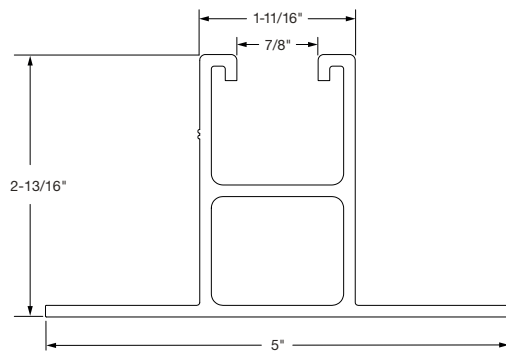

Skylo 5" Flat Profile

### PERFORMANCE DATA FOR SKYLO 5" FLAT SUSPENSION SYSTEMS

Beam Span/ Hanger Spacing (FT)	Mid-Span/Center Load <sup>^</sup> (LBS)		Allowable Uniform Area Load* (LBS/SF)		
	L/360 Deflection	L/240 Deflection	Panel Span (FT)	L/360 Deflection	L/240 Deflection
4	631	950	10.0	25.2	38.0
6	285	555	10.0	7.6	14.8

<sup>^</sup>Grid members tested in simple span configuration with concentrated mid-span point load  
\*Data calculated based on mid-span point load testing

# SKYLO™ – 5" Flat

## Walkable Suspension System



Declare.

RECYCLED CONTENT

UP TO  
**50%**

LEED V5

COMMON MATERIALS FRAMEWORK

Human Health **Declare Label**  
HPD  
3rd Party CDPH

Ecomedes Data

Climate Health **EPD**  
Ecosystem Health **EPD**  
Circular Economy **✓**

Well Building Standard™ (WELL)  
Living Building Challenge® (LBC)

### SKYLO™ 5" FLAT WALKABLE SUSPENSION SYSTEM INSTALLATION OVERVIEW

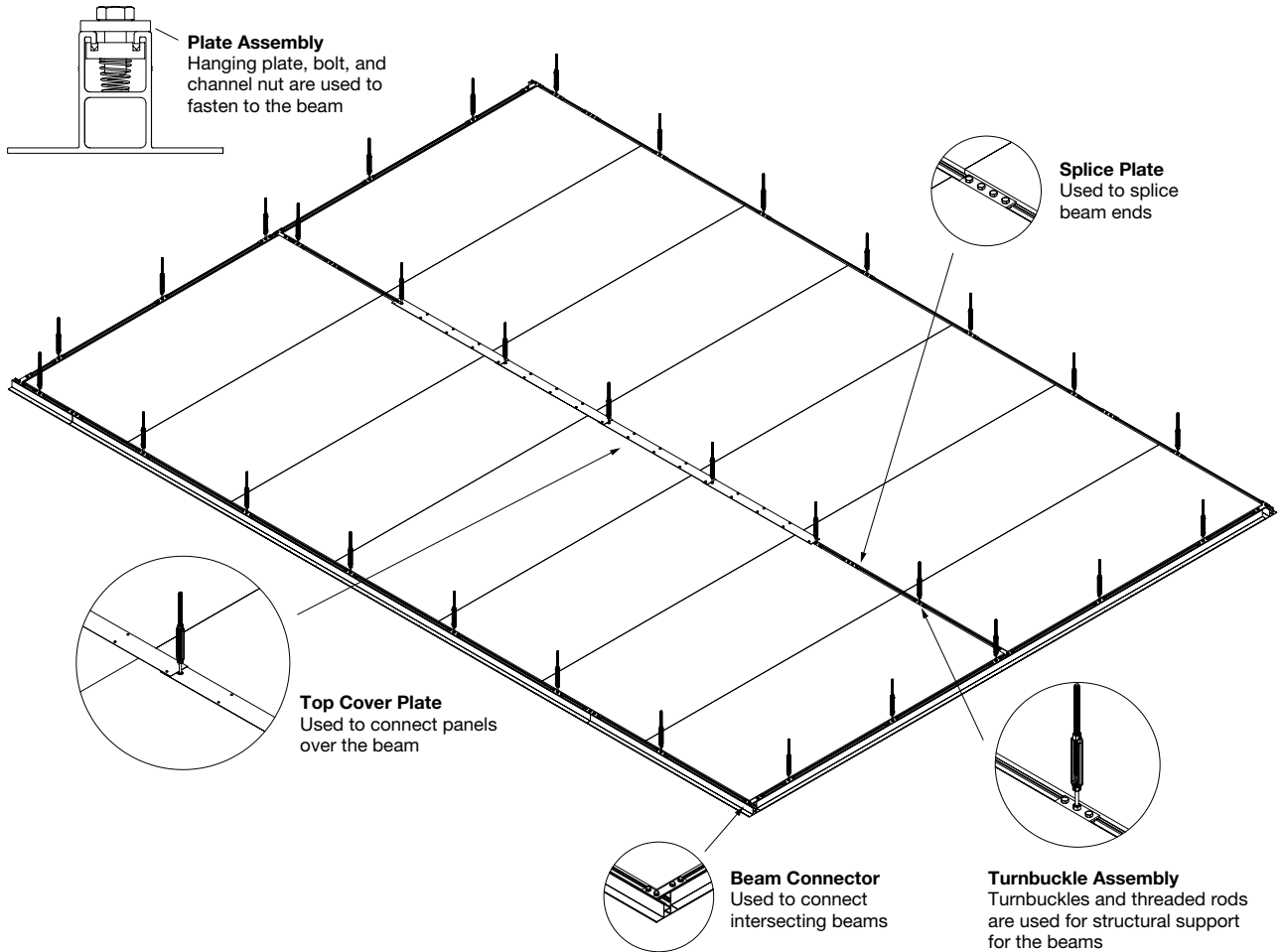

SUSPENSION SYSTEMS – CONTROLLED ENVIRONMENTS

# SKYLO™ – 5" Flat

## Walkable Suspension System



RECYCLED  
CONTENT

UP TO  
**50%**

LEED V5

Ecomedes Data

COMMON MATERIALS FRAMEWORK

Human Health	Declare Label	Climate Health	EPD
	HPD	Ecosystem Health	EPD
	3 <sup>rd</sup> Party CDPH	Circular Economy	✓

Well Building Standard™ (WELL)  
Living Building Challenge® (LBC)

### SKYLO™ 5" FLAT WALKABLE CEILING PANELS

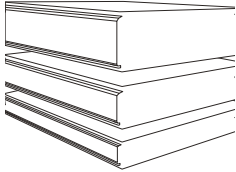
	Item No.	Description	Dimensions L x W	Available Options for Panels
	<b>SKYIMP80</b>	80mm Insulated Metal Panel	4' x 10'	ESD Painted Finish
	<b>SKYIMP100</b>	100mm Insulated Metal Panel	4' x 10'	ESD Painted Finish
	<b>SKYIMP120</b>	120mm Insulated Metal Panel	4' x 10'	ESD Painted Finish

NOTE: Panel sizes are nominal dimensions.

**COLORS** Due to printing limitations, shade may vary from actual product.

Painted



White  
(WH)

#### PHYSICAL DATA

**Material**  
6063-T6 Aluminum  
**Surface Finish**  
Powder coated  
**Face Dimension**  
5"  
**Profile**  
Exposed tee

#### CEILING PANELS PHYSICAL DATA

**Material**  
Cleanroom Facing: Galvanized Steel  
Interstitial Facing: Galvanized Steel  
Panel Core: IMP, Polyisocyanurate

