

SKYLO™ – 2" AMHS (Automated Material Handling System) Walkable Suspension System



Skylo 2" AMHS Walkable Suspension System

Skylo™ Walkable Ceiling Solutions are engineered for performance and constructability, delivering an efficient cleanroom ceiling solution that enables safe, convenient access to overhead equipment without compromising the controlled environment below.

KEY SELECTION ATTRIBUTES

- Skylo Walkable Ceiling Solutions are the market's only complete grid and panel system with load capacity data tested under ASTM E72
- Ideal combination of a finished ceiling system with a structural solution
- Main beam and cross tee grid system with flexible layouts available in 2' x 4' and 4' x 4' configurations
- Grid and panel system suitable for use in ISO Class 3-5 per ISO Standard 14644-1
- Tested and certified system capable of carrying 20-40 lbs/sq ft of live loads
- Seamless integration with honeycomb panels in 15, 25, or 60mm thickness to control dust and debris contamination

TYPICAL APPLICATIONS

- Semiconductor

COLORS Due to printing limitations, shade may vary from actual product.

Standard

Custom

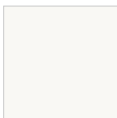

White
(WH)

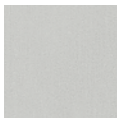

Anodized
Clear

White is standard color for main beams and cross tees.
All brackets and hardware are unfinished.



SKYLO™ – 2" AMHS (Automated Material Handling System) Walkable Suspension System



RECYCLED
CONTENT

UP TO
50%

LEED V5

Ecomedes Data

COMMON MATERIALS FRAMEWORK

Human Health

Declare Label

HPD

3rd Party CDPH

Climate Health

EPD

Ecosystem Health

EPD

Circular Economy

✓

Well Building Standard™ (WELL)
Living Building Challenge® (LBC)

VISUAL SELECTION

	Item No.	Description	Dimensions (Inches) L x W x H	PCS/ CTN	LF/ CTN
Skylo™ Walkable Suspension System	SKY2501	Main Beam	144 x 2 x 3-1/16"	4	48
	SKY25013	Main Beam	144 x 2 x 3-3/4"	4	48
	SKY25014	Main Beam	144 x 2 x 4"	4	48
	SKY2520	2' Cross Tee	24 x 2 x 3-1/16"	12	24
	SKY25203	2' Cross Tee	24 x 2 x 3-3/4"	12	24
	SKY25204	2' Cross Tee	24 x 2 x 4"	12	24
	SKY2540	4' Cross Tee	48 x 2 x 3-1/16"	12	48
	SKY25403	4' Cross Tee	48 x 2 x 3-3/4"	12	48
	SKY25404	4' Cross Tee	48 x 2 x 4"	12	48
	7800	Perimeter Molding	144 x 7/8 x 7/8"	30	360

NOTE: Contact local engineer for job specific load and/or seismic requirements.

ACCESSORIES

DMXB – X-Bracket
Used to connect all cross tees together for rigid connection

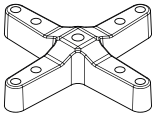

DMXB – 24 PCS

DMTB – T-Bracket
Used to connect main beams and cross tees to the perimeter extrusion

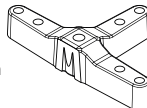

DMTB – 36 PCS

DMLB – L-Bracket
Used to connect perimeter extrusion corners together

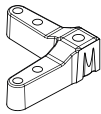

DMLB – 12 PCS

DMIB – I-Bracket
Used for supplemental hanging locations

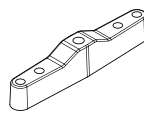

DMIB – 24 PCS

DMHWK – Hardware Kit
3/8" Turnbuckles and threaded rods are used to connect the x-brackets to the threaded rod to create a structural support for the grid

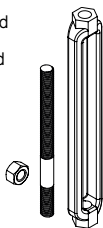

DMHWK – 12 PCS

DMMBS – Main Beam Splice
Used to splice together main beam ends

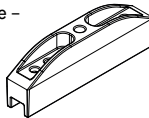

DMMBS – 24 PCS

DMHWK1238 – Hardware Kit with 1/2" Turnbuckle
1/2" Turnbuckles and threaded rods are used to connect the x-brackets to the threaded rod to create a structural support for the grid



DMHWK1238 – 12 PCS

SKY23HDC
Hold down clip for 15mm and 25mm panels

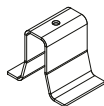

SKY23HDC – 200 PCS

SKY23HDC60
Hold down clip for 60mm panels

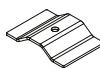

SKY23HDC60 – 200 PCS

DETAILS

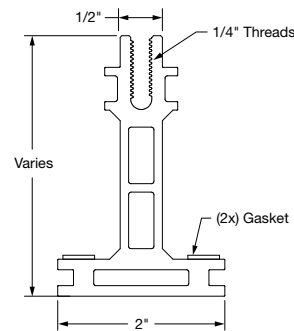

Skylo 2" AMHS Profile

PERFORMANCE DATA FOR SKYLO 2" AMHS SUSPENSION SYSTEMS

Grid	Beam Span/ Hanger Spacing (FT)	Mid-Span/Center Load** (LBS)		Allowable Uniform Area Load** (LBS/SF)		
		L/360 Deflection	L/240 Deflection	Panel Span (FT)	L/360 Deflection	L/240 Deflection
3-1/16" Profile	4	835	1252	4	83.5	125.2
3-3/4" Profile	4	1385	2078	4	138.5	207.8
4" Profile	4	1666	2500	4	166.6	250.0

**Data theoretically calculated based on material and section properties

OPTIONAL COVING ACCESSORIES

SKYCOVB – Cove L Support
Used to provide support to the corner cove

SKYCOV – PVC Coving 3.2M

Used to eliminate sharp corners and edges, providing a smooth transition that is easily cleanable

SKYCS – Internal Corner Cove

Used to close the gap between covings at the corners

TechLine 877 276-7876

armstrongceilings.com/skylo

Armstrong®
World Industries

SKYLO™ – 2" AMHS (Automated Material Handling System) Walkable Suspension System



Declare.

RECYCLED
CONTENT

UP TO
50%

LEED V5

Ecomedes Data

COMMON MATERIALS FRAMEWORK

Human Health **Declare Label**
HPD
3rd Party CDPH

Climate Health **EPD**
Ecosystem Health **EPD**
Circular Economy **✓**

Well Building Standard™ (WELL)
Living Building Challenge® (LBC)

SKYLO™ 2" AMHS WALKABLE SUSPENSION SYSTEM INSTALLATION OVERVIEW

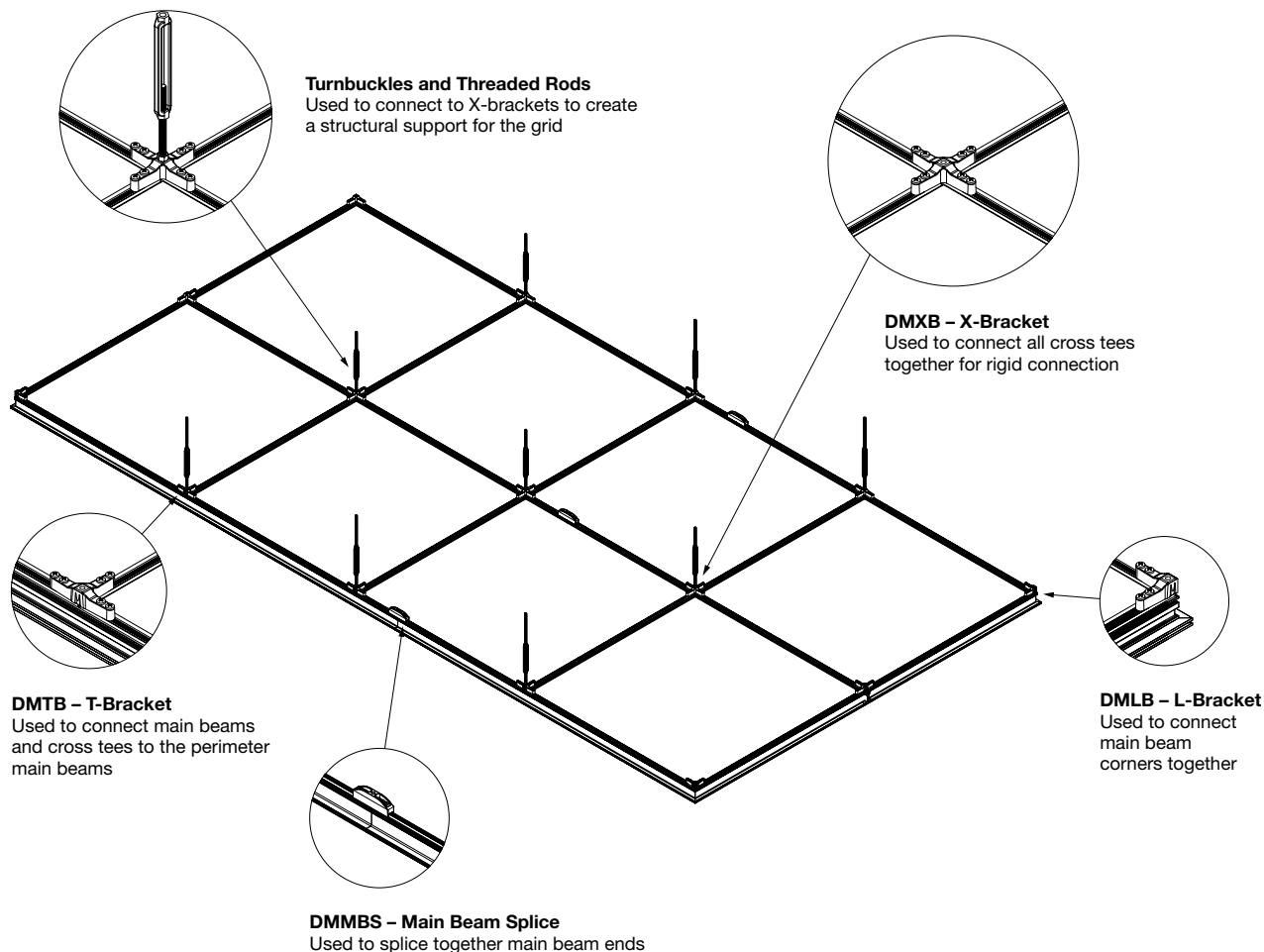

SUSPENSION SYSTEMS – CONTROLLED ENVIRONMENTS

SKYLO™ – 2" AMHS
(Automated Material Handling System)
Walkable Suspension System



RECYCLED
CONTENT

UP TO
50%

LEED V5
Ecomedes Data

COMMON MATERIALS FRAMEWORK

Human Health	Declare Label	Climate Health	EPD
	HPD	Ecosystem Health	EPD
	3rd Party CDPH	Circular Economy	✓

Well Building Standard™ (WELL)
Living Building Challenge® (LBC)

SKYLO™ 2" FLAT WALKABLE PANELS

	Item No.	Description	Dimensions	Available Options for Panels
	SKYHCP15	15mm Honeycomb Panel (non-walkable)	4' x 4'	ESD Painted Finish
	SKYHCP25	25mm Honeycomb Panel	4' x 4'	ESD Painted Finish 0.0625" Aluminum Diamond Tread Brite
	SKYHCP60	60mm Honeycomb Panel	4' x 4'	ESD Painted Finish 0.0625" Aluminum Diamond Tread Brite

NOTE: Panel sizes are nominal dimensions. 2' x 4' and additional panel sizes available by custom order.

COLORS Due to printing limitations, shade may vary from actual product.

Painted



PHYSICAL DATA

Material
6063-T6 Aluminum
Surface Finish
Powder coated with static dissipative coating
Gasketed Face Dimension
2"
Profile
Exposed tee

CEILING PANELS PHYSICAL DATA

Material
Cleanroom Facing: .032" Aluminum
Interstitial Facing: .032" Aluminum
Panel Core: Aluminum honeycomb .75" cell size, Alloy 3003,
Rustproof treatment, Density 20kg/m3