

PRELUDE® XL MAX® Exposed Tee System



Declare.

RECYCLED
CONTENT
UP TO
30%

LEED V5			Ecomedes Data
COMMON MATERIALS FRAMEWORK			
Human Health	Declare Label	Climate Health	EPD
	HPD	Ecosystem Health	EPD
	3rd Party CDPH	Circular Economy	✓

Well Building Standard™ (WELL)
Living Building Challenge® (LBC)



Prelude XL Max with DataZone™ ceiling panels (Item 1569)

This suspension system is designed to offer maximum air flow management, load-carrying capacity, and adaptability in data center applications.

KEY SELECTION ATTRIBUTES

Prelude® XL Max® 15/16" Suspension System

- 24" x 24" and 24" x 48" suspension system supports point loads up to 300 lbs. using 3/8" threaded rod and integrated hanging clips to provide:
 - Flexible and reconfigurable overhead cable tray and electrical distribution to meet client needs without a separate strut channel system
 - Eliminates unsightly threaded rod penetrations through the ceiling plane for improved access and aesthetics
 - Reduced ceiling penetrations help minimize unwanted air infiltration
- Prelude® XL Max® is part of the Sustain™ portfolio and meets the most stringent industry sustainability compliance standards today
- CleanAssure™ family of products – includes disinfectable panels, suspension systems, and trim (Cleaning and CDC approved disinfecting options available on armstrongceilings.com/cleaning)
- Suspension system meets ASTM C635, ASTM C636, ASTM E580, ICC-ES AC156 with Seismic D, E, F available
- 30-Year Limited System Warranty

- Standard 24" x 24" and 24" x 48" grid layouts allow for use of standard size lighting and specially sized Prelude XL Max ceiling tile options
- For custom layout information and technical guidelines, contact TechLine customer support at 877 276-7876.

TYPICAL APPLICATIONS

- Data Centers
- Laboratories
- Hospitals
- Industrial Warehouses/
Distribution Centers
- Retail/Convenience Stores

COLORS

Due to printing limitations, shade may vary from actual product.

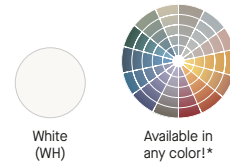

*Colors that are pre-qualified to meet Sustain™ portfolio requirements are available upon request. Other made-to-order colors must be evaluated if sustainability criteria is required. Lead time will increase.

White is standard color for main beams and cross tees. All clips are unfinished.
Custom colors and finishes are available for main beams, cross tees, load connector clips, and ceiling panels.
For custom layout information and technical guidelines, contact TechLine customer support at 877 276 7876.

VISUAL SELECTION

	Item No.	Description	Dimensions Nominal (Inches)	MAX LOADING* LBS/LF	
				2 Ft.	4 Ft.
Prelude XL Max 15/16"	730145	12' HD Main Beam	144 x 15/16 x 2-7/16"	135.5	40.17
	XL7345	4' Cross Tee	48 x 15/16 x 2-7/16"	N/A	40.17
	XL7325	2' Cross Tee	24 x 15/16 x 2-7/16"	93.82	N/A
Molding 7/8"	SWA9878HRC	12' Structural Wall Angle	144 x 7/8 x 7/8"	N/A	N/A

*Simple Span

PERFORMANCE

CleanAssure™ Disinfectable Grid				
Fire Guard™	Seismic Category	Fog	Spray	Wipe
DEF	DEF	DEF	DEF	DEF

N/A * * * *

N/A * * * *

N/A * * * *

N/A * * * *

Dots represent high level of performance.

PACKAGING

Pcs/ CTN	Lf/ CTN
10	120
30	120
30	60
12	144



Ceiling Panels for PRELUDE® XL MAX® Square Lay-in



SUSTAIN®
High Performance
Sustainable Ceiling Systems

Declare.

RECYCLED
CONTENT

UP TO
87%

LEED V5

Ecomedes Data

COMMON MATERIALS FRAMEWORK

Human Health	Declare Label	Climate Health	EPD
	HPD	Ecosystem Health	EPD
	3rd Party CDPH	Circular Economy	✓
OCCUPANT EXPERIENCE		Acoustics	✓

ACCESSORIES

PMHC – Prelude® Max Hanging Clip –
Used to carry the ceiling system with 3/8" threaded rod from structure.
(Machine screws, Heavy Hex Nut, and Locknut included)

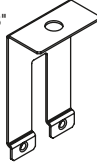

PMHC – 150 pcs
FZPMHC – 50 pcs

PMLC – Prelude® XL Max® Load Connector – Used to support busbar, cable trays, and other components with 3/8" threaded rod from the suspension system face.
(Heavy Hex Nut & Locknut included)

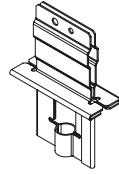

PMLC – 100 pcs
FZPMLC – 50 pcs

IJC – Intersection Joint Clip –
Used to connect all cross tees together for rigid connection.
(Machine screws included)

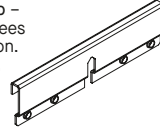

IJC – 250 pcs
FZIJC – 50 pcs

XTAC – Cross Tee Adapter Clip –
Securely attaches cross tees or main beams to the structural wall molding around the perimeter of the ceiling installation.

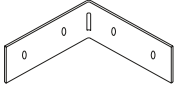

XTAC – 100 pcs
FZXTAC – 50 pcs

TLMBS – Top Lock Main Beam Splice Clip –
Locks two main beams together for a secure connection.

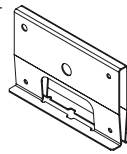

TLMBS – 50 pcs

PMHDC – Prelude® XL Max® Hold-down Clip –
Attaches to the top bulb of the Prelude® XL Max® suspension system to hold ceiling panels in place; helps to prevent ceiling panel movement.

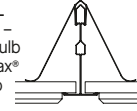

PMHDC – 100 pcs
FZPMHDC – 50 pcs

LSB – Lateral Support Bar
(Seismic Zone DEF Only)

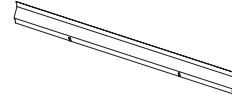

LSB12HRC – 10 pcs/120 LF
LSB10HRC – 10 pcs/100 LF
LSB8HRC – 10 pcs/80 LF

PRELUDE® XL MAX® INSTALLATION OVERVIEW

PMLC – Prelude® XL Max® Load Connector
Used to support bus bars, cable trays, and other components with 3/8" threaded rod along the suspension system face

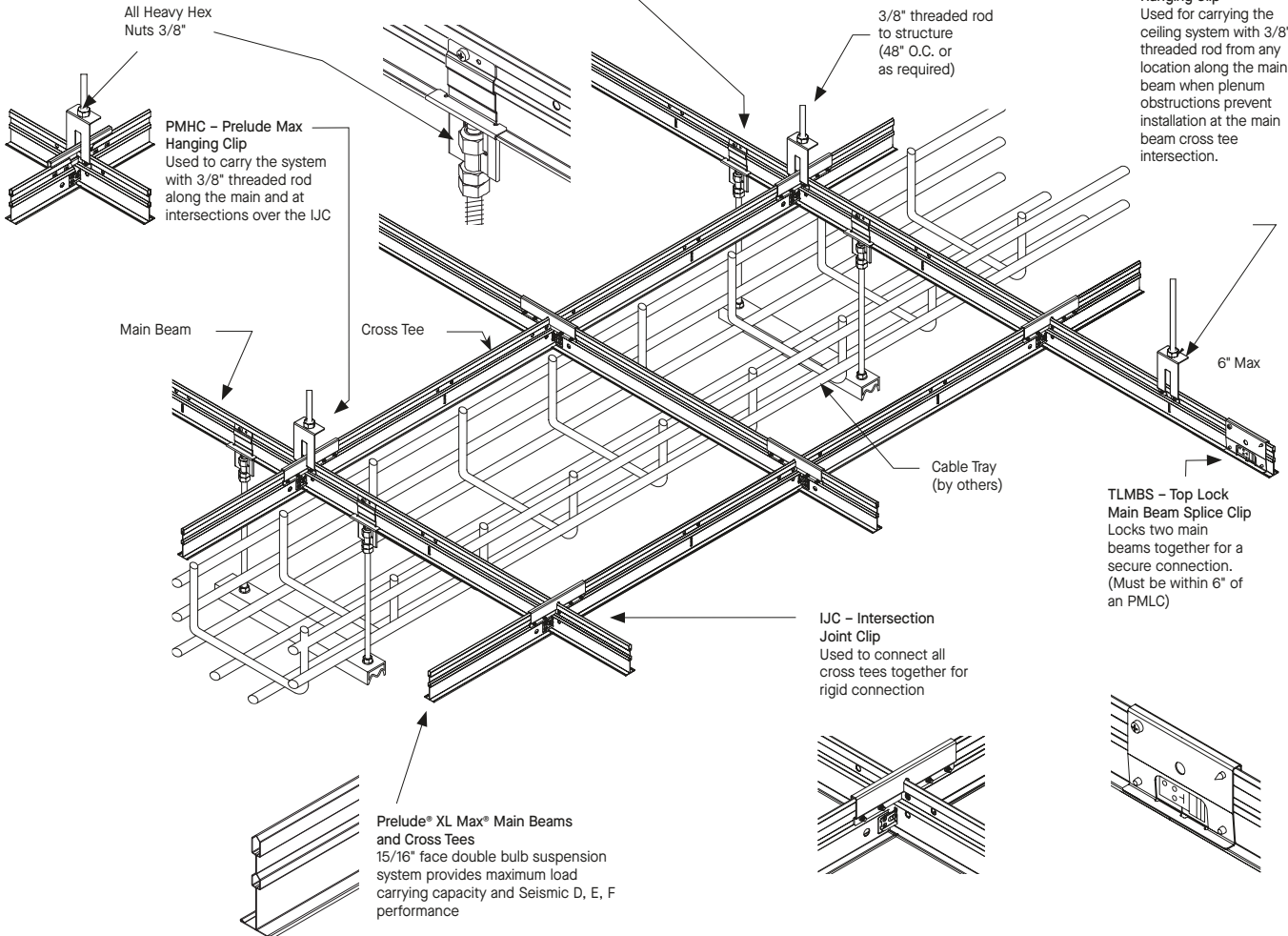



Ceiling Panels for PRELUDE® XL MAX® Square Lay-in



Declare.

RECYCLED
CONTENT

UP TO
87%

LEED V5

Ecomedes Data

COMMON MATERIALS FRAMEWORK

Human Health	Declare Label	Climate Health	EPD
	HPD	Ecosystem Health	EPD
	3rd Party CDPH	Circular Economy	✓
OCCUPANT EXPERIENCE		Acoustics	✓



DataZone™ panels with Prelude® XL Max® suspension system

Ceiling panels for Prelude® XL Max® are specifically designed for performance, reliability, and sustainability in a wide variety of applications.

KEY SELECTION ATTRIBUTES

DataZone™ for Prelude XL Max

- DataZone panels are part of the Sustain® portfolio, and meet the most stringent industry sustainability compliance standards today
- Get total noise control and floor plan versatility with Total Acoustics® ceiling panels: NRC + CAC = Total Acoustics performance
- Smooth, clean, durable finish – Washable, Impact-resistant, scratch-resistant, and soil-resistant
- Mold- and mildew-resistant surface
- 30-Year Limited System Warranty against visible sag, mold, and mildew
- Made in the U.S.A. of domestic and global content
- Build America, Buy America (BABA) Act compliant

Clean Room™ FL for Prelude XL Max

- Excellent sound blocking CAC (35)
- Durable – Washable, Scrubbable, Soil-resistant
- Non-directional visual reduces scrap and installation time
- Clean Room panels are part of the Sustain® portfolio, and meet the most stringent industry sustainability compliance standards today
- Mold- and mildew-resistant surface
- 30-Year Limited System Warranty against visible sag, mold, and mildew
- Made in the U.S.A. of domestic and global content
- Build America, Buy America (BABA) Act compliant

These panels are specially sized and engineered for Prelude XL Max and must be used with the system. These panels do not fit in other suspension systems.

COLORS Due to printing limitations, shade may vary from actual product.

Painted

DataZone for Prelude XL Max

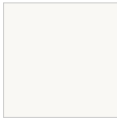

White
(WH)

Clean Room FL



White with
Gray Spatter

DETAILS

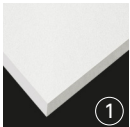

1

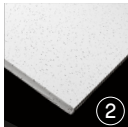

2

1. DataZone™ for Prelude XL Max
2. Clean Room FL



PRELUDE® XL MAX®

Exposed Tee System



Declare.

RECYCLED
CONTENT

UP TO
30%

LEED V5

Ecomedes Data

COMMON MATERIALS FRAMEWORK

Human Health

Declare Label

HPD

3rd Party CDPH

Climate Health

EPD

Ecosystem Health

EPD

Circular Economy



Well Building Standard™ (WELL)
Living Building Challenge® (LBC)

VISUAL SELECTION

	Item No.	Dimensions (Inches)
DataZone™ for Prelude® XL Max®	1569	23-13/16 × 23-13/16 × 3/4"
Square Lay-in	1570	23-13/16 × 47-13/16 × 3/4"
Clean Room™ FL for Prelude® XL Max®	1815*	23-13/16 × 23-13/16 × 3/4"
Square Lay-in	1816*	23-13/16 × 47-13/16 × 3/4"
	1720 (Border Panel)	24 × 24 × 5/8"
	1721 (Border Panel)	24 × 48 × 5/8"

PERFORMANCE SELECTION

Dots represent highest level of performance.

Sound Absorption	Sound Blocking	Total Acoustics¹	Fire Performance	Light Reflect	Bio- Block Mildew	Humi- Guard+	Certified Low VOC Emissions	Durability	Recycled Content	Recycle Program	30-Yr Warranty
NRC	CAC	NRC + CAC									
0.75	35	BETTER	Class A	0.82	*	*	*	Std	*	*	*
0.75	35	BETTER	Class A	0.82	*	*	*	Std	*	*	*
0.55	35	N/A	Class A	0.79	*	*	*	*	*	-	*
0.55	35	N/A	Class A	0.79	*	*	*	*	*	-	*
0.55	35	N/A	Class A	0.79	*	*	*	*	*	-	*
0.55	35	N/A	Class A	0.79	*	*	*	*	*	-	*

NOTE: Specify Items 1720 and 1721 for borders.

Ceiling panels are specially sized and engineered for Prelude XL Max and must be used with the system. These panels do not fit in other suspension systems.

* Clean Room FL items 1815 and 1816 cannot be cut for borders and can only be used as full size panels.

¹ Total Acoustics® ceiling panels have an ideal combination of noise reduction and sound blocking performance in one product.

GOOD (NRC 0.60-0.65; CAC 35+) **BETTER** (NRC 0.70-0.75; CAC 35+) **BEST** (NRC 0.80+; CAC 35+)

PRELUDE® XL MAX®

Exposed Tee System



Declare.

RECYCLED
CONTENT

UP TO
30%

LEED V5

Ecomedes Data

COMMON MATERIALS FRAMEWORK

Human Health	Declare Label	Climate Health	EPD
	HPD	Ecosystem Health	EPD
	3rd Party CDPH	Circular Economy	✓

Well Building Standard™ (WELL)
Living Building Challenge® (LBC)

LIGHTING INTEGRATION

Lighting solutions are available through partner companies.

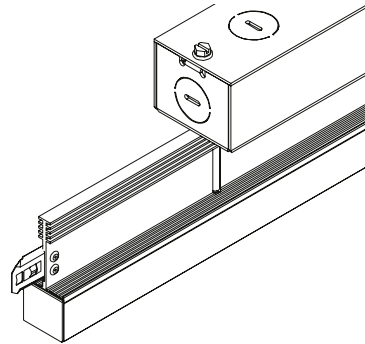

TeraLyte™ 1" for
Prelude® XL Max® System

DETAILS

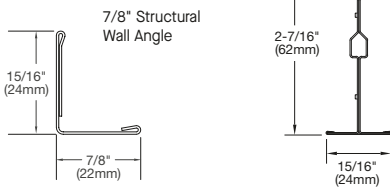

Prelude® XL Max®
Main Beam &
Cross Tee

PHYSICAL DATA FOR DATAZONE™ AND CLEAN ROOM™ FL CEILING PANELS

Material

Wet-formed mineral fiber with acoustically transparent membrane (Items 1569 and 1570)

Wet-formed mineral fiber (Items 1815, 1816, 1720, and 1721)

Surface Finish

Acoustically transparent membrane with factory-applied latex paint (Items 1569 and 1570)

Soil-resistant polyester film (Items 1815, 1816, 1720, and 1721)

Fire Performance

Class A: ASTM E84 and CAN/ULC S102 surface burning characteristics. Flame Spread Index of 25 or less. Smoke Developed Index of 50 or less (UL® labeled).

ASTM E1264 Classification

Type A, Form A2.2, Pattern G; Fire Class A

Humidity/Sag Resistance

HumiGuard® Plus ceiling panels are recommended for areas subject to high humidity, up to, but not including, standing water and outdoor applications.

Anti-Mold/Mildew

Ceiling tiles with BioBlock® performance resist the growth of mold and mildew on the tile surface.

VOC Emissions

Third-party certified compliant with California Department of Public Health CDPH/EHLB/Standard Method Version 1.2, 2017. This standard is the guideline for low emissions in LEED®, WELL Building Standard™, Living Building Challenge® (LBC), CalGreen Title 24, ANSI/ASHRAE/USGBC/IES Standard 189; ANSI/GBI Green Building Assessment Protocol.

High Recycled Content

Contains greater than 50% total recycled content. Total recycled content based on product composition of post-consumer and pre-consumer (post-industrial) recycled content per FTC.

Insulation Value

1569 and 1570:
R Factor – 2.2 (BTU units); R Factor – 0.39 (Watts units)
1815, 1816, 1720, and 1721:
R Factor – 1.5 (BTU units); R Factor – 0.26 (Watts units)

30-Year Performance Guarantee & Warranty

When installed with Armstrong® Suspension System. Details at armstrongceilings.com/warranty

Weight; Square Feet/Carton

1569, 1570 – 1.08 LBS/SF; 48 SF/CTN
1815 – 1.02 LBS/SF; 48 SF/CTN
1816 – 1.02 LBS/SF; 64 SF/CTN
1720 – 1.04 LBS/SF; 48 SF/CTN
1721 – 1.17 LBS/SF; 64 SF/CTN

Minimum Order Quantity

1 carton

GRID PHYSICAL DATA

Material

Hot dipped galvanized steel

Surface Finish

Baked polyester paint or powder coated
Manufactured and tested in accordance with ASTM C635

Face Dimension

15/16"

Profile

Exposed tee

Cross Tee/Main Beam Interface
Override

End Detail

Main Beam: Staked-on clip

Cross Tee: Staked-on clip

Duty Classification

Heavy-duty

PHYSICAL DATA FOR PRELUDE® XL MAX® CEILING PANELS

Design Considerations

All acoustical grid and Axiom trim accessories (a.k.a. clips) are supplied as unpainted items. Exposed clips will need to be field painted after installation, if required for the project. This ensures accessories meet the tested performance criteria and adhere to AWI installation instructions and warranted products or systems.

TechLine / 877 276-7876
armstrongceilings.com/preludexlmax
BPCS-4933-1025

LEED® is a registered trademark of the U.S. Green Building Council; Declare® and Living Building Challenge® (LBC) are registered trademarks of the International Living Future Institute; WELL™ and Well Building Standard are trademarks of the International WELL Building Institute; JLC-Tech TeraLyte™ are trademarks of JLC-Tech, LLC; UL is a registered trademark of UL LLC; all other trademarks used herein are the property of AWI Licensing LLC and/or its affiliates © 2025 AWI Licensing LLC

Armstrong®
World Industries

SUSPENSION SYSTEMS – DATA CENTERS