

# METALWORKS™ Linear – Synchro®

## Standard Wall Planks

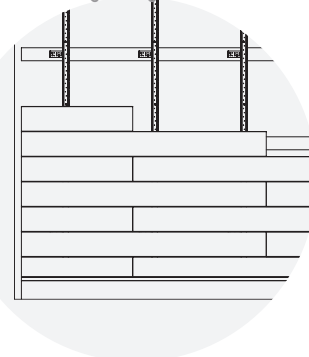

CAD/Revit® drawings at:  
[armstrongceilings.com/cadrevit](http://armstrongceilings.com/cadrevit)



plus capabilities  
to do more

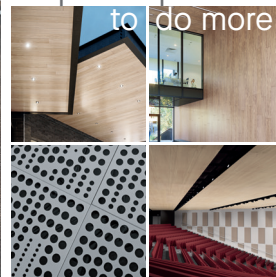

MetalWorks™ Linear – Synchro® 6" planks in Tech Black

[armstrongceilings.com/capabilities](http://armstrongceilings.com/capabilities)  
 See more photos at:  
[armstrongceilings.com/photogallery](http://armstrongceilings.com/photogallery)

Durable, metal wall planks install in both horizontal and vertical orientations for design flexibility and contribute to healthy spaces for interiors

### KEY SELECTION ATTRIBUTES



Install 4", 6", & 9" wide Linear – Synchro® planks on interior wall applications horizontally or vertically with no additional clips or brackets needed

Achieve high sound absorption for increased acoustical performance with microperforated planks – 0.70 NRC



MetalWorks™ Linear – Synchro® panels are part of the Sustain™ portfolio, and meet the most stringent industry sustainability compliance standards today

Planks easily snap into upper hooks of new Main Beam Carrier (item 7277S3MF)

CleanAssure™ family of products – includes disinfectable planks, suspension systems, and trim

Linear – Synchro wall planks are available in 4 standard metal finishes and 17 Effects™ wood-look finish options

Smooth monolithic visual with durable metal planks – perfect for high traffic areas

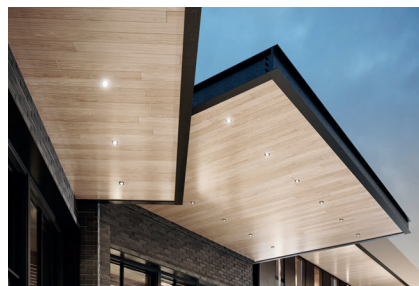

*Also  
Available  
for Ceilings!*

# METALWORKS™ Linear – Synchro®

## Standard Wall Planks



Declare.

RECYCLED  
CONTENT  
UP TO  
**35%**

**LEED V5**

COMMON MATERIALS FRAMEWORK	
Climate Health	EPD
Human Health	EPD
3rd Party CDPH	
Circular Economy	
OCCUPANT EXPERIENCE	Acoustics
	✓



MetalWorks™ Linear – Synchro® 4", 6", 9" planks in Effects™ Macadamia

### STANDARD COLORS & FINISHES

Due to printing limitations, shade may vary from actual product.

MetalWorks™ (Interior only)

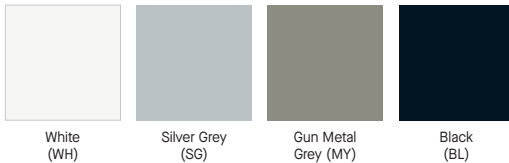

Effects™ Classic  
Dye-Sublimation



Effects™ Bold  
Dye-Sublimation



Effects™ Subtle  
Dye-Sublimation



### CUSTOM COLORS & FINISHES

Due to printing limitations, shade may vary from actual product.



For custom options contact ASQuote,  
ASQuote@armstrongceilings.com

### PERFORATION OPTIONS

(1:2 scale shown)

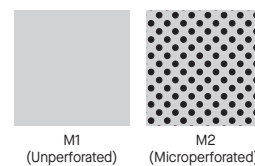

# METALWORKS™ Linear – Synchro® Standard Wall Planks



Declare.

RECYCLED  
CONTENT

UP TO  
**35%**

LEED V5

COMMON MATERIALS FRAMEWORK

Human Health

Climate Health

Ecosystem Health

EPD

EPD

3rd Party CDPH

Circular Economy

OCCUPANT EXPERIENCE

Acoustics



## VISUAL SELECTION

Item No. ♦	Description	Dimensions Nominal W × L × D (Inches) Custom Sizes Available	Module Width (Inches)
METALWORKS™ Linear – Synchro® Planks			
8223W04 _ _ _ _ _	4" Plank	4 × 96 × 1"	4.50"
8223W06 _ _ _ _ _	6" Plank	6 × 96 × 1"	6.75"
8223W09 _ _ _ _ _	9" Plank	9 × 96 × 1"	9.00"

## PERFORMANCE

Dots represent high level of performance.

Fire Performance	(M1 White only) Light Reflect	CleanAssure™ Disinfectable Planks					DURABILITY					(M2 Perf only) Acoustics
Fire	Light	Fog	Spray	Wipe	Wash	Scrub	Impact	Scratch	Soil			Acoustics
Class A	0.83	*	*	*	*	*	*	*	*	*		0.70
Class A	0.83	*	*	*	*	*	*	*	*	*		0.70
Class A	0.83	*	*	*	*	*	*	*	*	*		0.70

♦ When specifying or ordering, include the appropriate 2-letter perforation suffix and 2- or 4-letter color suffix (e.g., 8223W04 M 1 E X C H, 8223W09 M 2 S G).

## ACCESSORIES

Item No. ♦	Description	Finish Selection – Interior	Pieces/ Carton
8161	Pressure Spring	N/A	50
8233W04M1_ _ _ _	4" End Cap	WH, SG, MY, BL, and all Effects™ Wood Looks	10
8233W06M1_ _ _ _	6" End Cap	WH, SG, MY, BL, and all Effects Wood Looks	10
8233W09M1_ _ _ _	9" End Cap	WH, SG, MY, BL, and all Effects Wood Looks	10
8243W02	2" Splice Plate	N/A	10
8243W04	4" Splice Plate	N/A	10
8243W06	6" Splice Plate	N/A	10
7113	Spreader Hold Down	N/A	40
GSUTC	Rigid Attachment Clip	N/A	150
7237S3	Synchro Cut Plank Bracket	N/A	25
BERC2	BERC2 Clip	BL	200
XTACAG	XTAC Clip	BL	200
GCWA	GCWA Clip	BL	250

♦ When specifying or ordering, include the appropriate 2- or 4-letter color suffix (e.g., 8233W04M1 S G, 8233W04M1 E X C H).



PARTITIONS & WALLS

# METALWORKS™ Linear – Synchro®

## Standard Wall Planks



Declare.

RECYCLED  
CONTENT  
UP TO  
**35%**

**LEED V5**

COMMON MATERIALS FRAMEWORK

Human Health

Climate Health

Ecosystem Health

EPD

EPD

3rd Party CDPH

Circular Economy

OCCUPANT EXPERIENCE

Acoustics



### SUSPENSION SYSTEM COMPONENTS

Item No. ♦	Description	Dimensions Nominal L x W x H (Inches)	Pieces/ Carton	Color
7277S3MF	Main Beam Carrier (MBC) – Mill Finish	144 x 1-3/4 x 2-3/4"	10	N/A
5574_ _ _ _	Carrier Molding	120 x 1 x 1"	10	N/A
7800_ _ _ _	Hemmed Angle Molding	144 x 7/8 x 7/8"	30	WH, BL
XL8926	2' Drywall Cross Tee	24 x 1-1/2 x 1-1/2"	36	BL

♦ When specifying or ordering, include the appropriate 2- or 4-letter color suffix (e.g., 7800 M Y, 5574 E X C H).

### INSTALLATION DETAILS – WALLS

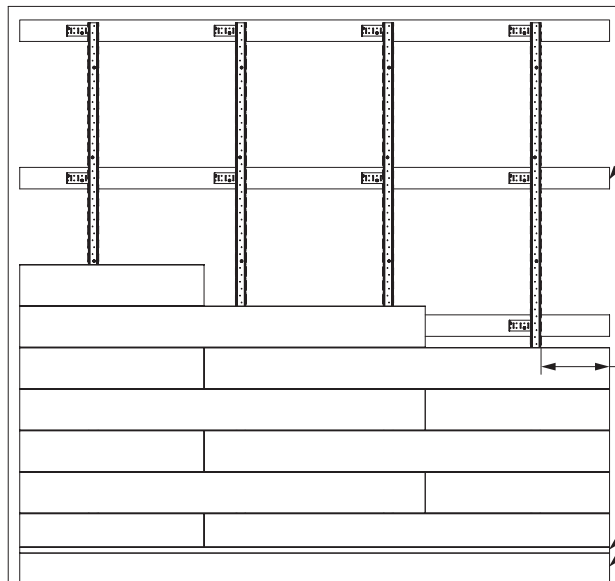

Main Beam Carrier (MBC) installs on the wall perpendicular to desired plank length direction

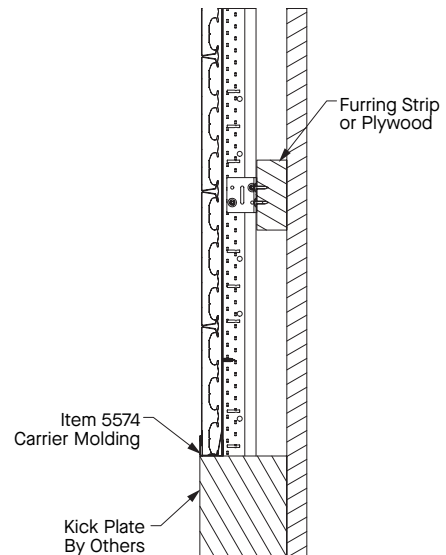

Install QSUTC to furring strips or 5/8" plywood, securing them with appropriate fasteners for the substrate to the structure

### PHYSICAL DATA

**Material**  
Electrogalvanized Steel – thickness 0.028"

**Surface Finish**  
Available in White, Silver Grey, Gun Metal Grey, Tech Black, and Effects™ Wood Looks powder-coated, post-production finishes. Custom colors are also available, contact ASQuote@armstrongceilings.com for custom requests.

**Plank Reveal**  
MetalWorks Linear – Synchro planks have a butt joint installation with no reveal between planks for a monolithic visual.

**Fire Performance**  
Class A: ASTM E84 and CAN/ULC S102. Flame Spread Index 25 or less. Smoke Developed Index 50 or less.

**ASTM E1264 Classification**  
Fire Class – Class A  
Unperforated – Type XX, Form 2, Pattern G  
Perforated – Type XX, Form 2, Pattern C

**Seismic Restraint**  
MetalWorks Linear – Synchro planks have been engineered, tested, and approved for application in all seismic areas when installed per Armstrong Ceilings installation instructions.

When installed properly, both planks and suspension have been tested to stay in place through vibrations and other seismic events.

**Cleaning and Disinfecting**

Cleaning and CDC approved disinfecting options available on [armstrongceilings.com/cleaning](http://armstrongceilings.com/cleaning)

**Warranty**  
Details at [armstrongceilings.com/warranty](http://armstrongceilings.com/warranty)

**Weight; Pcs and SF/Carton**  
8223W04 – 4.45 lbs/pc; 12 pcs/ctn; 36 SF/ctn  
8223W06 – 6.05 lbs/pc; 8 pcs/ctn; 36 SF/ctn  
8223W09 – 7.95 lbs/pc; 6 pcs/ctn; 36 SF/ctn