

WOODWORKS™ ACGI Linear System

Closed Series 1

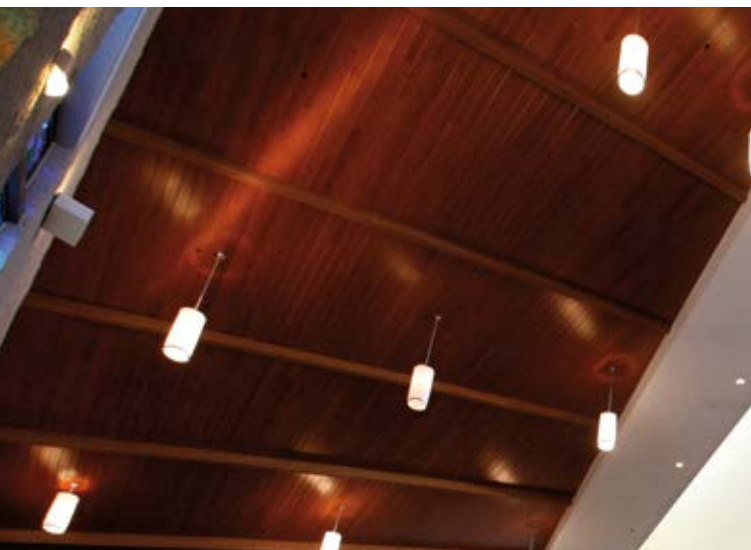

Linear Closed Series 1 (LC1) is designed with a tongue-and-groove edge for a continuous plank ceiling or wall. Wood veneer LC1 planks supplied in 8' and 10' typical lengths. Solid wood LC1 planks supplied as random lengths from 4'-10'. Standard LC1 planks are 3/4" thick (other thicknesses available upon request). Standard plank widths are 3-1/4" and 5-1/4", with job specific plank widths available upon request. LC1 planks install using concealed clips (LSC-101). Ceiling applications suspend from Armstrong® Prelude® XL® grid. Access panels or doors are optional in areas where frequent access above the ceiling is required. Wall applications attach using sheathing or furring strips.

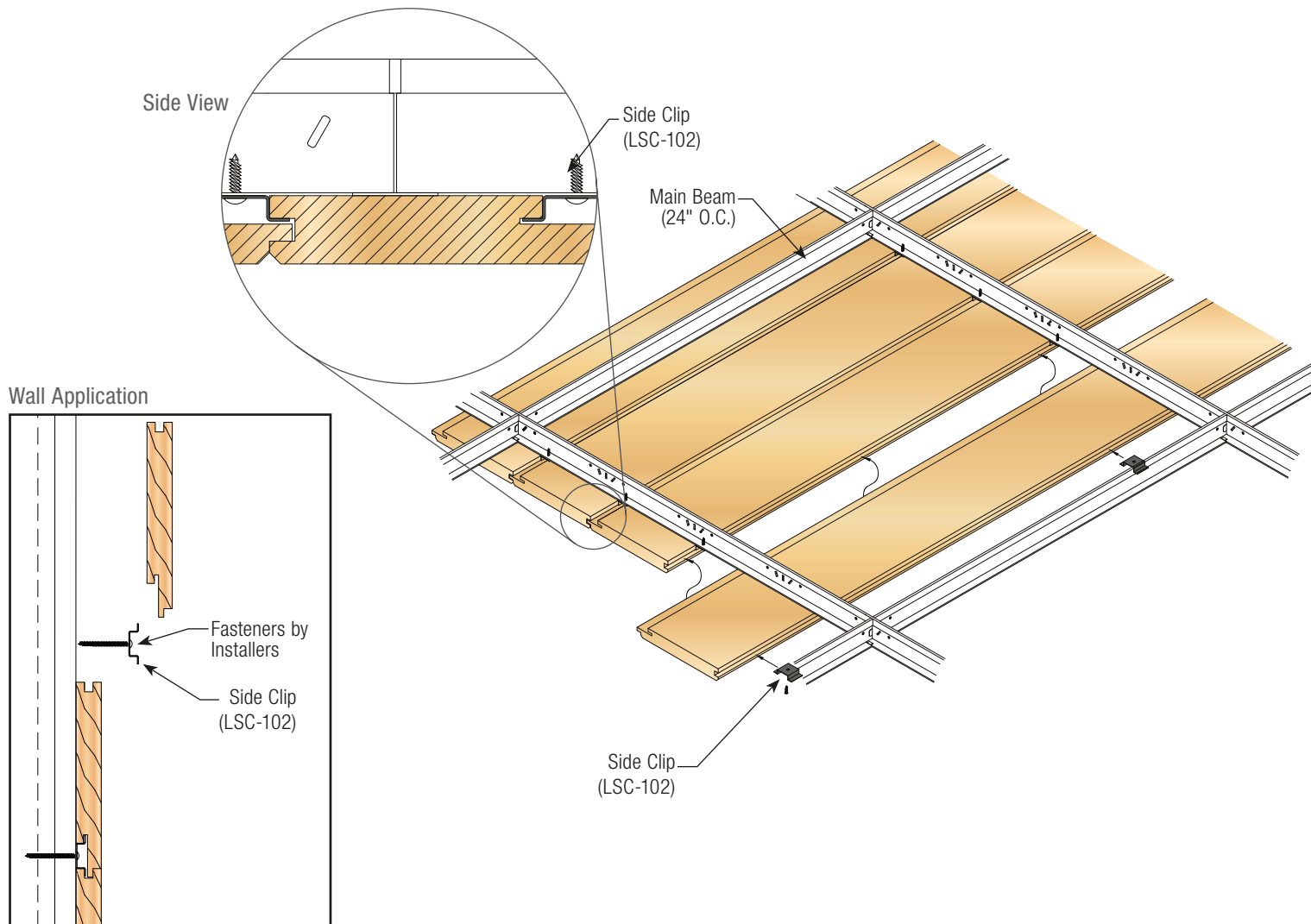

Linear Closed Series 1 – Specification Information					
Product No.	Suspension	Reveal	Solid Wood Width	Veneer Width	Typical Thickness
LC1-####-C	Side Clip	Closed	Up to 5-1/4"	Up to 6"	3/4"

* With veneered planks, substrate material will be visible with profiles A, B, and C. Please discuss available options with your local Armstrong Ceilings Sales Representative before specifying.

How To Spec It...

Series — Thickness ●.....

LC1-375-C

Width —

What It Means... Linear Closed Series 1 plank 3-3/4" wide and 3/4" thick.

Thickness Reference	
● C	3/4"
D	7/8"
E	1"
F	1-1/8"
G	1-1/4"
H	1-3/8"
I	1-1/2"

Standard Reveal Profiles

Reveal A – Solid wood

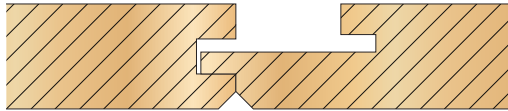

Reveal B – Solid wood

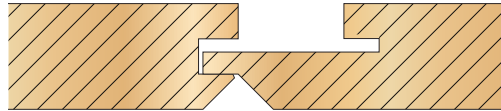

Reveal C – Solid wood

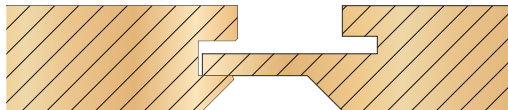

Reveal D – Solid wood or veneer

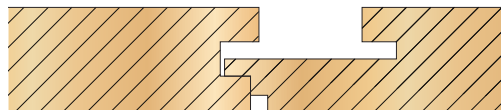

Reveal E – Solid wood or veneer

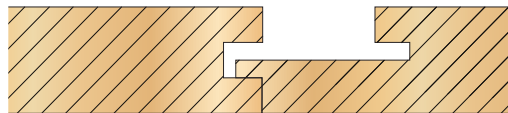

ACOUSTICS

NRC up to 0.80

LEED® CREDIT

Depending upon product it may contribute to LEED credits. Contact us for more information.

SPECIES + STAINS

Linear Closed 1 is available in solid and wood veneers to meet design requirements. Linear Closed1 can be finished in any of our standard finish options or custom finishes. Please see Wood Species + Stain Catalog. Contact us for more information.

FIRE RATING

Solid Wood – Class C: ASTM E84 surface burning characteristics. Class B available with fire rated treatment. Veneer Wood (Non-Perforated) – Class A: ASTM E84 surface burning characteristics.

DELIVERY, STORAGE & HANDLING (FOR INTERIOR APPLICATION ONLY)

Material must be stored and installed only in secured ambient environment (humidity range 25%–55%, temperature not to exceed 86°F). All windows, doors, and wet-work must be complete before installation. Handle carefully to avoid damaging.

WARRANTY

Details at armstrongceilings.com/warranty