

new AXIOM® Light Covers – Direct
For Specialty Ceilings



SUSTAIN™
High Performance
Sustainable
Ceiling Systems



▲ Axiom® Direct Light Covers

Axiom® extruded aluminum direct light covers offer ultra low plenum clearance, predictable lighting performance, and integration with select specialty ceilings.

KEY SELECTION ATTRIBUTES

- Low profile design with plug-and-play lighting for easy installation in shallow plenums
- CleanAssure™ family of products – includes disinfectable panels, suspension systems, and trim
- Pre-engineered, extruded aluminum light cover profiles integrate with XAL® LENO® or Axis Click light fixtures
- Adjustable trim clip allows for a range of 0" to 3-1/4" to accommodate your specialty ceilings
- Axiom Direct Light Covers are part of the Sustain™ portfolio and meet the most stringent industry sustainability compliance standards today

TYPICAL APPLICATIONS

- Offices
- Retail
- Hospitality
- Healthcare

LIGHTING FIXTURES

- Compatible with:
- Axis Lighting and XAL® Leno® Luminaire



COLORS Due to printing limitations, shade may vary from actual product.

Axiom Trim Finish Selection

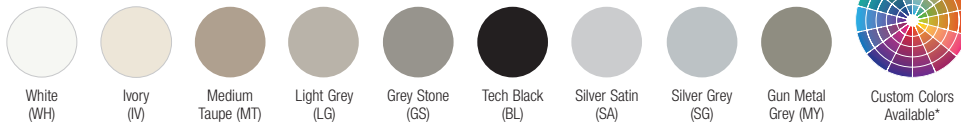

* Colors that are pre-qualified to meet Sustain™ portfolio requirements are available upon request. Other made-to-order colors must be evaluated if sustainability criteria is required. Lead time will increase.

VISUAL SELECTION

| | Item No. | Description | Dimensions (Inches) | |
|---|-----------|---|---------------------|--|
| Axiom® Direct Light Covers for Specialty Ceilings | AXDLC46AS | 4 x 6" Direct Light Cove for Specialty Ceilings | 120 x 4-1/2 x 6" | |
| | AXDLC44AS | 4 x 4" Direct Light Cove for Specialty Ceilings | 120 x 4-1/2 x 4" | |

Direct Light Covers: Aluminum extrusions formed with distinct architectural detail groove on bottom flange with special bosses to receive the T-Bar Connection Clip, Hanging Clip, and Splice Plate, provides positive mechanical lock with no visible fasteners. Factory-finished to match approved samples.

ASSEMBLY DRAWING

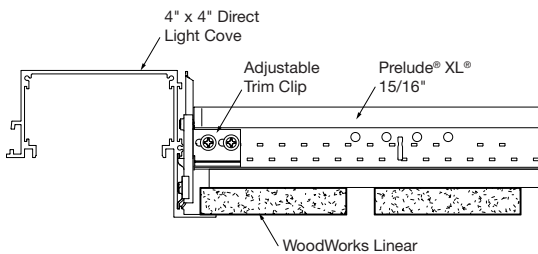

new AXIOM® Light Covers – Direct
For Specialty Ceilings



LEED® WELL™ LBC

50% RECYCLED CONTENT

energy management, construction waste mgmt, regional materials, design for flexibility, EPD, recyclable/producer resp., biobased materials, recycled content, sourcing of raw materials, material ingredient reporting, low emitting materials, lighting quality, acoustics

Calculate sustainability with GreenGenie™ armstrongceilings.com/greengenie

Well Building Standard™ (WELL) Living Building Challenge® (LBC)

COMPATIBLE SPECIALTY CEILINGS

- | | |
|--------------------|-------------------|
| MetalWorks™ | WoodWorks® |
| • Torsion Spring | • Grille |
| • Linear | • Grille Tegular |
| • Clip-On | • Concealed |
| • Open Cell | • Torsion Spring |
| • 3D | • Open Cell |
| • Synchro™ | • Linear |
| • Diverge™ | |

SPECIALTY CEILINGS FINISH SELECTION

See MetalWorks™ or WoodWorks® Standard Ceilings/Standard Finishes (Excludes Anodized and Effects™ colors)

ACCESSORIES (7239 and AX4SPLICE are included with order)

| Item No. | Description |
|----------|----------------------|
| 7239 | Adjustable Trim Clip |

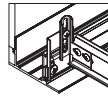

| | |
|-----------|---|
| AX4SPLICE | Splice Plate for Axiom® Direct Light Covers |
|-----------|---|

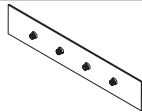

END CAPS

| Item No. | Description |
|--------------|---|
| AXDLC44ASECL | 4" x 4" – Direct Light Cover for Specialty Ceilings End Cap - Left |
| AXDLC44ASECR | 4" x 4" – Direct Light Cover for Specialty Ceilings End Cap - Right |
| AXDLC46ASECL | 4" x 6" – Direct Light Cover for Specialty Ceilings End Cap - Left |
| AXDLC46ASECR | 4" x 6" – Direct Light Cover for Specialty Ceilings End Cap - Right |

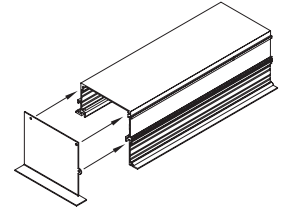

COMPATIBLE LIGHT FIXTURES

Lighting and diffuser solutions are available through partner companies

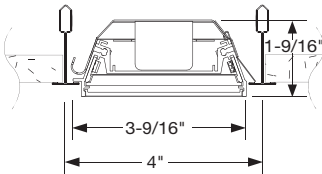

Connect-Insert-Click – shallow linear system that installs from below:

- 1-3/4" shallow housing – same height as T-Bar
- Install and maintain from below with no need for access from above
- Can be installed after ceiling has been closed
- Ultra-thin lightguide technology delivering comfortable, uniform illumination along entire lens
- Seismic-tested and approved luminaire
- Hinged driver cover with full driver and wiring access

For compatible lighting details, visit axislighting.com

Lighting and diffuser solutions are available through partner companies

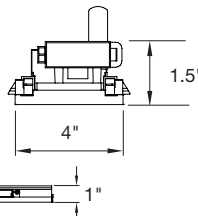
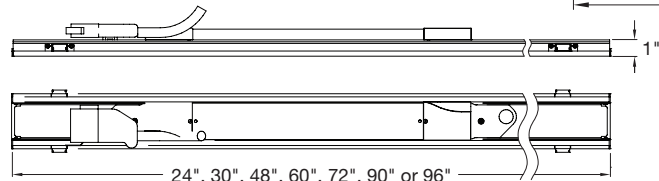

The new ultra thin XAL® LENO® Zero Plenum luminaire installs from below and features:

- High output, energy efficient LED lighting for any space
- High performance opal cover for uniform illumination and enhanced glare control
- Extruded aluminum fixture design
- White powder coated finish
- Integrated plug and play electrical connections
- Choice of light outputs to achieve any desired light level
- Dimming options available

For compatible lighting details, visit XALUSA.com

PHYSICAL DATA

Material
Commercial quality extruded aluminum alloy 6063

Surface Finish
Factory-applied baked polyester paint finish

Warranty
10-Year Limited Warranty; 30-Year System Warranty

Profile
4" x 4" and 4" x 6" Light Cover with 3/4" horizontal flange

Cross Tee/Main Beam Interface
Flush Fit

End Detail
Splice with screws

Cleaning & Disinfecting
Cleaning and CDC approved disinfecting options available on armstrongceilings.com/cleaning

ICC Reports
For areas under ICC jurisdiction, see evaluation report numbers ESR-1289 and ESR-1308 for allowable values and/or conditions of use concerning the suspension system components listed on this page. The reports are subject to reexamination, revisions, and possible cancellation.

TechLine / 1 877 276-7876
armstrongceilings.com/lighting
BPCS-6499-821

LEED® is a trademark of the U.S. Green Building Council; Declare® and Living Building Challenge® (LBC) are trademarks of the International Living Future Institute®; WELL™ and Well Building Standard are trademarks of the International WELL Building Institute; XAL®, XAL® LENO®, and the XAL logo are trademarks of XAL GmbH; Axis logo is a trademark of Axis Lighting Inc.; all other trademarks used herein are the property of AWI Licensing LLC and/or its affiliates © 2021 AWI Licensing LLC



TRIM & TRANSITIONS – Standard