

new ACOUSTIBuilt®
Seamless Acoustical Wall System
fine texture

TOTAL ACOUSTICS®
Sound Absorption (NRC)
+ Sound Blocking (CAC)

SUSTAIN®
High Performance
Sustainable
Ceiling Systems
(white only)

24/7 DEFEND™
Solutions for Healthier,
Safer Spaces

CONTAIN CLEAN PROTECT

CAD/Revit® drawings at:
armstrongceilings.com/cadrevit

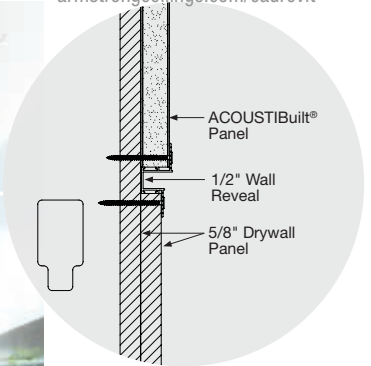

View full ACOUSTIBuilt® Ceiling
and Walls System offering at:
armstrongceilings.com/acoustibuilt

plus capabilities
to do more



armstrongceilings.com/capabilities
See more photos at:
armstrongceilings.com/photogallery

▲ ACOUSTIBuilt® Seamless Acoustical Wall System

New seamless acoustical wall system that looks like drywall, but offers acoustical performance.

KEY SELECTION ATTRIBUTES

- new** • Wall application allows for a seamless acoustical wall system (install on walls above 7 feet to prevent damage)
- Get total noise control and floor plan versatility with Total Acoustics® ceiling panel options: NRC + CAC = Total Acoustics performance
- Finished White ACOUSTIBuilt® panels are part of the Sustain® portfolio and meet the most stringent industry sustainability compliance standards today
- new** • Smooth non-directional, monolithic, drywall-like visual
- Add a hint of color, tailored to your design palette
- new** • Use Drywall Grid SimpleSoffit™ framing system for faster, easier soffit construction
- Similar installation and finishing methods to drywall ceilings
- new** • CleanAssure™ family of products – includes disinfectable panels, suspension systems, and trim
- Mold and mildew-resistant surface
- ACOUSTIBuilt® is intended for spaces desiring a Level 4 equivalent drywall finish
- Easier to install than acoustical plaster at a lower cost
- new** • Improves STC of interior stud/drywall partition systems by up to 6 points*

TYPICAL APPLICATIONS

- Offices
- Lobbies
- Education
- Exposed Structure
- Retail
- Hospitality

FINE TEXTURE FINISH FOR ACOUSTIBuilt® PANELS



COLOR TINTS OF YOUR CHOICE



NOTE: Custom color tints should have an LRV (Light Reflectance Value) of 70 or greater. Custom ACOUSTIBuilt® fine texture finish colors will appear 1 to 2 shades darker than a standard paint color sample when applied due to the texture in the finish.

new ACOUSTIBuilt®

Seamless Acoustical Wall System
fine texture

USDA
CERTIFIED
BIOBASED
PRODUCT
PRODUCT 98%

SUSTAIN®
High Performance
Sustainable Ceiling Systems
(white only)

GREENGUARD
Gold Certified
(details below)

Declare.

LEED® WELL™ LBC
UP TO 75% RECYCLED CONTENT

- energy management
- construction waste mgmt
- regional materials
- design for flexibility
- EPD
- recyclable/producer resp.
- biobased materials
- recycled content
- sourcing of raw materials
- material ingredient reporting
- low emitting materials
- lighting quality
- acoustics

LOCATION DEPENDENT

Calculate sustainability with GreenGenie™
armstrongceilings.com/greengenie

VISUAL SELECTION

Item No.	Dimensions (Inches)
ACOUSTIBuilt® Wall Panels 7/8" 4-Sided Tapered Edge	2604 48 x 72 x 7/8"

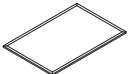

PERFORMANCE SELECTION

Dots represent high level of performance (panel and grid).

UL Classified Acoustics	Total Acoustics ¹	Fire Performance	Light Reflect	Anti-Mold/Mildew	Sag Resistant	Certified Low VOC Emissions	CleanAssure™ Disinfectable Panels	DURABILITY	Recycle Program	10-Yr Warranty
NRC + CAC	NRC CAC	Class	Light Reflect	Anti-Mold/Mildew	Sag Resistant	Certified Low VOC Emissions	Fog Spray Wash Scratch Soil	Recycle Program	10-Yr Warranty	
0.80* + 46	BEST	Class A	0.87**	•	•	•	Fog Spray Wash Scratch Soil	Recycle Program	10-Yr Warranty	

¹ Total Acoustics® ceiling panels have an ideal combination of sound absorption and sound-blocking in one product.
* Per ASTM C423 & E795, E-400 Mounting
** White Fine Texture Finish panel performance following the installation instructions.

STANDARD ACCESSORIES BY OTHERS – Order Separately

Item No.	Description	Required for Install
Screws	# 6 x 1-5/8" coarse thread drywall screws (Used for Wall Installations)	Yes
Setting-Type Compound	Fast-setting compound (hot mud)	Yes
Adhesive (Required for all ceiling and wall installations.)	Loctite® PL Premium® Polyurethane Construction Adhesive or OSI® F38 Drywall Panel Adhesive	Yes
Drying-Type Compound	Ready-mixed lightweight compound	Yes
Tape	Self-adhesive mesh drywall joint tape (For Panel Joints)	Yes
Paper Tape	Paper drywall tape (For Corners)	Yes

ACOUSTICAL INFORMATION

Wall Application	Mounting Method/STC Rating***
1 Side	2 Sides
0.42	0.43

*** 3-5/8" metal studs with one layer of 5/8" drywall on both sides and ACOUSTIBuilt Panels on one or both sides.

PERIMETER TRIM OPTIONS – Order Separately

Item No.	Description	Required for Install
new ARM625500STR	1/2" Wall reveal from 7/8" ACOUSTIBuilt to 5/8" Drywall	Based on layout

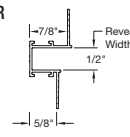

ACOUSTIBUILT FINE TEXTURE FINISH PAINT – Order Separately

Item No.	Description	Required for Install
2605WH	Fine Texture Finish for ACOUSTIBuilt® Panels (available in white and custom off-white tints)	For every 10 panels (240 SF) - order 1 pail (4 gal.) 200 SF on custom color applications

PHYSICAL DATA

Material
Wet-formed mineral fiber

Fire Performance
Class A: ASTM E84 and CAN/ULC S102 surface burning characteristics. Flame Spread of 25 or less. Smoke Developed of 50 or less.

ASTM E1264 Classification
Type IV, Form 2, Pattern G
Fire Class A

Humidity/Sag Resistance
HumiGuard® Plus ceiling panels are recommended for areas subject to high humidity, up to, but not including, standing water and outdoor applications.

Anti-Mold/Mildew
Ceiling tiles with White Fine Texture Finish offer BioBlock® performance and resist the growth of mold and mildew on the tile surface.

High Recycled Content
Contains greater than 50% total recycled content. Total recycled content based on product composition of post-consumer and pre-consumer (post-industrial) recycled content per FTC guidelines.

VOC Emissions
GREENGUARD Gold Certified
Third-party certified compliant with California Department of Public Health CDPH/EHLB/Standard Method Version 1.2, 2017. This standard is the guideline for low emissions in LEED®, WELL Building Standard™, Living Building Challenge® (LBC), CalGreen Title 24, ANSI/ASHRAE/USGBC/IES Standard 189; ANSI/GBI Green Building Assessment Protocol

Design and Lighting Considerations
ACOUSTIBuilt® panels are intended for spaces desiring a Level 4 equivalent drywall finish. Critical lighting conditions such as grazing or side light are important to consider while specifying as they can accentuate any imperfections or visible joints.

Lighting and diffuser fixtures must be able to accommodate 7/8" thick panels. Contact the lighting and diffuser manufacturers for recommended fixture use and integration. ACOUSTIBuilt® is a non-accessible ceiling. Access panels can be integrated, as needed, following standard installation practices. Refer to access panel manufacturer to verify compatibility with 7/8" thick panels.

Acoustical Considerations
When installed as a cloud, average sound absorption is 0.80 Sabins/SF. The addition of acoustical infill panel item 8200T10 can increase sound absorption up to 1.33 Sabins/SF.

PRODUCT CERTIFIED FOR LOW CHEMICAL EMISSIONS
UL.COM/GG
UL 2818



Excessive integrations and/or small enclosed spaces where the ceiling is more compound than open area will result in degradation of sound absorption. Certain lighting conditions and/or colors may require an additional coat of Fine Texture Finish, resulting in a degradation of sound absorption. ACOUSTIBuilt® panels absorb the most sound when installed as full panels. Plan the layout to minimize panel joints and fixture integrations which cover the surface of the ceiling.

Insulation Value
R Factor – 2.2 (BTU Units)
R Factor – 0.39 (Watts Units)

Cleaning and Disinfecting
Cleaning and CDC recommended disinfecting options available on armstrongceilings.com/cleaning

10-Year Panel Warranty
Details at armstrongceilings.com/acoustibuilt

Weight; Square Feet/Carton
2604 – 1.1lbs/SF; 240 SF/ctn

Minimum Order Quantity
1 carton (10pcs)



PARTITIONS & WALLS