

**new** ACOUSTIBUILT®

Seamless Acoustical Ceiling and Wall System  
fine texture



CAD/Revit® drawings at:  
[armstrongceilings.com/cadrevit](http://armstrongceilings.com/cadrevit)

AcoustiBuilt Seamless Acoustical Ceiling System



AcoustiBuilt Ceiling System in Black Fine-Texture Finish

Seamless acoustical ceiling and wall system that looks like drywall, but offers Total Acoustics® performance.

**KEY SELECTION ATTRIBUTES**

- Smooth, non-directional, monolithic, drywall-like visual (Level 4 equivalent finish)
- Get total noise control and floor plan versatility with Total Acoustics® ceiling panel options: NRC + CAC = Total Acoustics performance – up to 0.80 NRC / CAC 46
- The AcoustiBuilt® ceiling system is part of the Sustain® portfolio and meets the most stringent industry sustainability compliance standards today
- Available in standard White and Black finishes, plus custom colors to meet your design palette

- Install on Armstrong® FrameAll® Drywall Grid, in any room, any size for wall-to-wall, cloud, curved, sloped, soffit, or wall applications (install on walls above 7 feet to prevent damage)
- Mold- and mildew-resistant surface
- Use AcoustiBuilt® system for open-air plenum applications
- Faster and easier to install and repair than acoustical plaster at a lower cost
- Easy light fixture and diffuser integration
- Wide range of Axiom® perimeter trim and lighting integration options
- Made in the U.S.A. of domestic and global content
- Build America, Buy America (BABA) Act compliant

**TYPICAL APPLICATIONS**

- Offices
- Lobbies
- Education
- Exposed Structure
- Retail
- Hospitality
- Cloud Applications
- Curved Ceiling Applications

**FINE-TEXTURE FINISH FOR ACOUSTIBUILT® PANELS**

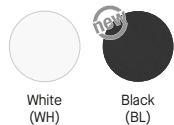

AcoustiBuilt panels must be sprayed with Armstrong Fine-texture Finish for AcoustiBuilt. Do not use paint of any other kind on AcoustiBuilt panels.

**CUSTOM COLORS AVAILABLE**



Available in custom colors from most major paint manufacturers and Pantone® colors.

NOTE: Custom AcoustiBuilt® Fine-texture Finish colors will appear 1 to 2 shades darker than a standard paint color sample when applied due to the texture in the finish. Metallic colors and gloss finishes are not available.

COMMON MATERIALS FRAMEWORK

Human Health	<b>Declare Label</b>	Climate Health	<b>EPD</b>
	<b>HPD</b>	Ecosystem Health	<b>EPD</b>
	<b>3rd Party CDPH</b>	Circular Economy	<b>✓</b>
OCCUPANT EXPERIENCE		Acoustics	<b>✓</b>

VISUAL SELECTION

Item No.	Dimensions (Inches)
ACOUSTIBUILT® Ceiling and Wall Panels	2604 48 × 72 × 7/8"

7/8" Tapered Edge on 4 Sides

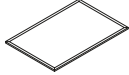

PERFORMANCE SELECTION Dots represent high level of performance (panel and grid).

NRC	CAC	Total Acoustics <sup>1</sup>	Fire Performance	Light Reflect	Anti-Mold/Mildew	Sag Resistant	Certified Low VOC Emissions	CleanAssure™ Disinfectable Panels	DURABILITY	Recycle Program	10-Yr Warranty
0.80*	46	<b>BEST</b>	Class A	0.87**	•	•	•	Fog Spray Wash Scratch Soil	N/A N/A N/A	•	•

<sup>1</sup> Total Acoustics® ceiling panels have an ideal combination of sound absorption and sound blocking in one product.  
\* Unfinished panel performance per ASTM C423 & E795, E-400 mounting.  
\*\* White fine-texture finish panel performance following the installation instructions.

WALL-TO-WALL ASSEMBLY AND INSTALLATION OVERVIEW

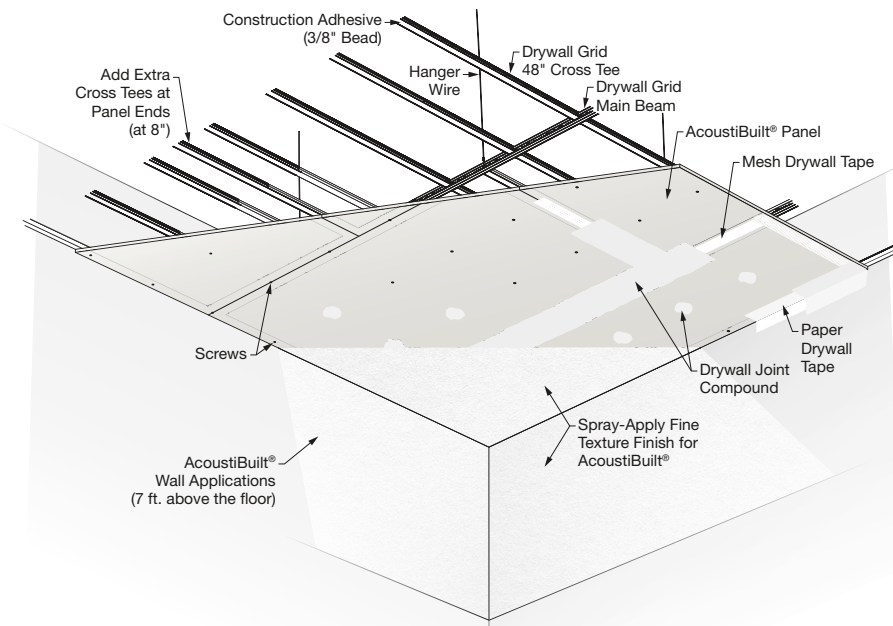

ACOUSTICAL INFORMATION

Mounting Method	NRC
Cloud	0.80
Cloud w/ infill 8200T10	1.33

STC Rating***	1 Side	2 Sides
	42	43

\*\*\* 3-5/8" metal studs with one layer of 5/8" drywall on both sides and AcoustiBuilt Panels on one or both sides.

PHYSICAL DATA

Material

Wet-formed mineral fiber.

Fire Performance

Class A: ASTM E84 and CAN/ULC S102 surface burning characteristics. Flame Spread of 25 or less. Smoke Developed of 50 or less.

ASTM E1264 Classification

Type A, Form A2.2, Pattern G; Fire Class A

Humidity/Sag Resistance

HumiGuard® Plus ceiling panels are recommended for areas subject to high humidity, up to, but not including, standing water and outdoor applications.

Anti-Mold/Mildew

Ceiling panels with BioBlock® performance resist the growth of mold and mildew on the panel surface.

High Recycled Content

Contains greater than 50% total recycled content. Total recycled content based on product composition of post-consumer and pre-consumer (post-industrial) recycled content per FTC guidelines.

VOC Emissions

Third-party certified compliant with California Department of Public Health CDPH/EHLB/Standard Method Version 1.2, 2017. This standard is the guideline for low emissions in LEED®, WELL Building Standard™, Living Building Challenge® (LBC), CalGreen Title 24, ANSI/ASHRAE/USGBC/IES Standard 189; ANSI/GBI Green Building Assessment Protocol.

Design and Lighting Considerations

AcoustiBuilt® panels are intended for spaces desiring a Level 4 equivalent drywall finish. Like Level 4 drywall, critical or low-angle light grazing across the ceiling can show imperfections. Special attention to finishing and sanding may be required. Downlights can complement the appearance in severe grazing light.

Installation is similar to standard wallboard and drywall suspension systems. However, it requires more precision and a higher level of finish to achieve an acceptable appearance. Lighting conditions can magnify surface imperfections, especially natural light that shines from oblique angles. It is strongly recommended that a job site mockup be constructed with representative lighting so that expectations regarding the finished appearance are managed.

Lighting and diffuser fixtures must be able to accommodate 7/8" thick panels. Contact the lighting and diffuser manufacturers for recommended fixture use and integration. AcoustiBuilt is a non-accessible ceiling. Access panels can be integrated, as needed, following standard installation practices. Refer to access panel manufacturer to verify compatibility with 7/8" thick panels.

Acoustical Considerations

AcoustiBuilt is a field-finished product. The final visual and acoustical performance is dependent on the installer. Proper techniques and tools as shown in the installation instructions on Armstrong.com must be followed. Finish calibration samples are available through our sample center: Item BPCS-6119 – White finish and BPCS-6981 – Black finish.

When installed as a cloud, average sound absorption is NRC 0.80. The addition of acoustical infill panel Item 8200T10 can increase sound absorption up to NRC 1.33. Excessive integrations and/or small enclosed spaces where the ceiling is more compound than open area will result in degradation of sound absorption. Certain lighting conditions and/or colors may require an additional coat of fine-texture finish, resulting in a degradation of sound absorption. AcoustiBuilt panels absorb the most sound when installed as full panels. Plan the layout to minimize panel joints and fixture integrations which cover the surface of the ceiling.

Insulation Value

R Factor – 2.2 (BTU Units)  
R Factor – 0.39 (Watts Units)

Cleaning and Disinfecting

Cleaning and CDC-recommended disinfecting options available on [armstrongceilings.com/cleaning](http://armstrongceilings.com/cleaning)

10-Year Panel Warranty

Details at [armstrongceilings.com/acoustibuilt](http://armstrongceilings.com/acoustibuilt)

Weight; Square Feet/ Carton

2604 – 1.1 LBS/SF; 240 SF/CTN

Minimum Order Quantity

1 carton (10 PCS)



# ACOUSTIBUILT®

Seamless Acoustical Ceiling and Wall System  
fine texture



RECYCLED CONTENT

UP TO 70%

LEED V5

Ecomedes Data

COMMON MATERIALS FRAMEWORK

Human Health	Declare Label	Climate Health	EPD
	HPD	Ecosystem Health	EPD
	3rd Party CDPH	Circular Economy	✓
OCCUPANT EXPERIENCE		Acoustics	✓

## SUSPENSION SYSTEMS – Order Separately

Item No.	Description	Required for Install	Qty/Ctn
HD8906	12' HD Drywall Main Beam	Yes	12/144
XL8945P	4' Drywall Cross Tee	Based on layout	36/144
KAM21020	2 x 2 x 120" Knurled Angle Molding (0.033" metal thickness)	Based on layout	10/100
SSLU2424	SimpleSoffit® L Soffit Upturn 6-1/2 x 1-3/4 x 48-1/2"	N/A	12/48
7891	12-gauge hanger wires 144" length	N/A	140 pcs

## PERIMETER TRIM OPTIONS – Order Separately

Item No.	Description	Required for Install
AX1PC_STR AX1PC_CUR	Axiom® One-Piece Drywall Trim available for 4" and 6" heights – straight or curved	Based on layout
AX_STR AX_CUR	Axiom Classic Trim available in 2" to 16" heights (2" increments – straight or curved) with Axiom Bottom Trim for AcoustiBuilt®	Based on layout
AXBTASTR AXBTACUR	Axiom Bottom Trim	Axiom Bottom Trim is required to use Axiom Classic and select Axiom Trims with AcoustiBuilt
AXAKECBSTR	Axiom® Angled Knife Edge® Trim for AcoustiBuilt – Inside or Outside Corner	Based on layout
AXAKECBIC	Inside Corner	
AXAKECBC	Outside Corner	
ARM625500STR	1/2" Wall reveal from 7/8" AcoustiBuilt to 5/8" Drywall	Based on layout

## CURVED CEILING APPLICATIONS

Item No.	Description	Required for Install	Qty/Ctn
HD8906F08	12' Faceted Drywall Main Beam	Curved layouts only	12/44
RC2	Radius Clip	N/A	205 PCS

## ACOUSTIBUILT FINE-TEXTURE FINISH PAINT – Order Separately

Item No.	Description	Required for Install
2605WH (White) 2605BL (Black)	Fine-texture Finish for AcoustiBuilt Panels (available in White, Black, and custom colors)	For every 10 panels (240 SF) – order 1 pail (4 gal.) 200 SF on custom color applications

NOTE: AcoustiBuilt panels **must** be sprayed with Armstrong Fine-texture Finish for AcoustiBuilt. Do not use paint of any other kind on AcoustiBuilt panels. Doing so will eliminate acoustical performance and void the product warranty.

## ACCESSORIES BY OTHERS – Order Separately

Item No.	Description
Screws	# 6 x 1-5/8" fine thread, corrosion-resistant drywall screws # 6 x 1-5/8" coarse thread drywall screws (used for wall installations)
Setting-Type Compound	Fast-setting compound (hot mud)
Adhesive (Required for all ceiling and wall installations.)	Requires approx. seven 28-oz. tubes of adhesive per 240 SF.

## CASTWORKS® GFRG ACCESS PANELS FOR ACOUSTIBUILT

Item No.*	Description
AS0300S02T7G0CPG	12 x 12 x 7/8" Squared Corners Lay-in
AS0300S04T7G0CPG	18 x 18 x 7/8" Squared Corners Lay-in
AS0300S05T7G0CPG	24 x 24 x 7/8" Squared Corners Lay-in
AS0300R02T7G0CPG	12 x 12 x 7/8" Rounded Corners Lay-in
AS0300R04T7G0CPG	18 x 18 x 7/8" Rounded Corners Lay-in
AS0300R05T7G0CPG	24 x 24 x 7/8" Rounded Corners Lay-in

See more Access Panel options at: [armstrongceilings.com/castworksaccesspanels](http://armstrongceilings.com/castworksaccesspanels)  
\* CastWorks access panels are designed for seamless integration with AcoustiBuilt panels as frames are 7/8" thick.

Item No.	Description
Drying-Type Compound	All-purpose joint compound Lightweight compound
Tape	Self-adhesive mesh drywall joint tape (for panel joints) FibaFuse® drywall joint tape (use with automatic finishing tools)
Paper Tape	Paper drywall tape (for corners)



ACOUSTIBUILT® CEILING AND WALL SYSTEM

COMMON MATERIALS FRAMEWORK

Human Health	<b>Declare Label</b>	Climate Health	EPD
	<b>HPD</b>	Ecosystem Health	EPD
	<b>3rd Party CDPH</b>	Circular Economy	✓
OCCUPANT EXPERIENCE		Acoustics	✓

LIGHTING AND MEP INTEGRATION

AcoustiBuilt® installed on FrameAll® Drywall Grid offers comparable compatibility to standard drywall and easily accommodates a wide variety of conventional and integrated lighting solutions from Armstrong lighting partners. Additional options include standard industry lighting that complements the module size, or pendant fixtures that hang below the ceiling system.



AcoustiBuilt with Axiom® Direct Light Cove

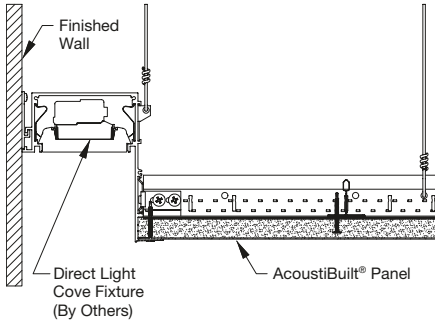

AcoustiBuilt with Axiom Linear Lighting

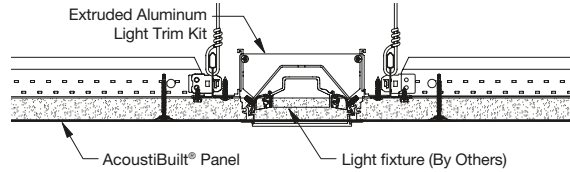

AcoustiBuilt with Trimless Downlighting

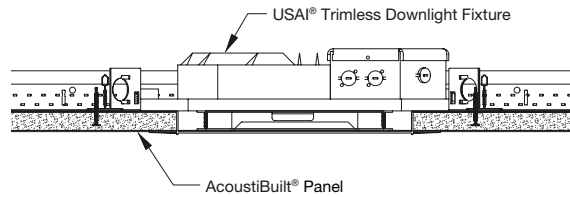

MEP PARTNERS

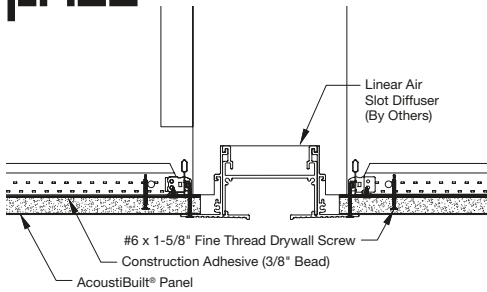

AcoustiBuilt with SimpleSoffit®

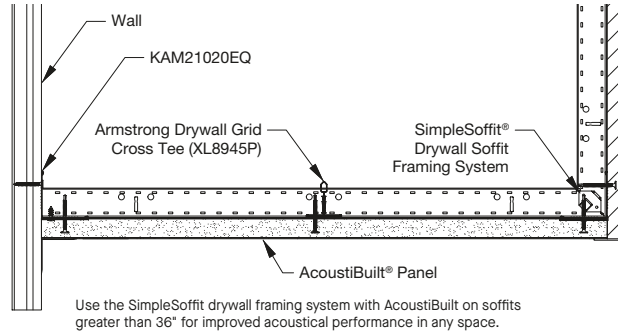

[Download AcoustiBuilt Drawing Details Library >](#)

VIDASHIELD UV24™

	Item No.	Description
VidaShield UV24 Air Purification System	52CHZUVC	VidaShield UV24 Air Purification System for Calla® Health Zone™ (Coordinates with AcoustiBuilt)
	52LUVC	VidaShield UV24 Air Purification System LED Light Panel
Installation Kits	52DACBTK	VidaShield UV24 Drywall/AcoustiBuilt Trim Kit

See VidaShield UV24 Air Purification System data page for complete details.

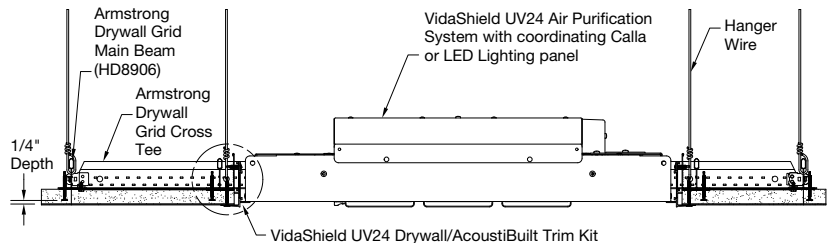

Axis is owned by Axis Lighting Inc.; BASO™ is a trademark of BASO, Inc.; USAI® is a registered trademark of USAI Lighting, LLC; Flexhead® is a registered trademark of Anvil International; Price® is a registered trademark of Price Industries Limited; Titebond® is a trademark of Franklin International; VidaShield UV24 is the property of Medical Illumination International, Inc.; Revit® is a registered trademark of Autodesk, Inc.; Pantone is registered trademark of Pantone, LLC; all other trademarks used herein are the property of AWI Licensing LLC and/or its affiliates © 2025 AWI Licensing LLC

