

new ACOUSTIBUILT®

Seamless Acoustical Wall System
fine texture



TOTAL ACOUSTICS®
Sound Absorption (NRC)
+ Sound Blocking (CAC)



SUSTAIN®
High Performance
Sustainable
Ceiling Systems



ACOUSTIBUILT® Wall Panels
Drywall
Wall Reveal for Drywall and ACOUSTIBUILT®

CAD/Revit® drawings at:
armstrongceilings.com/cadrevit

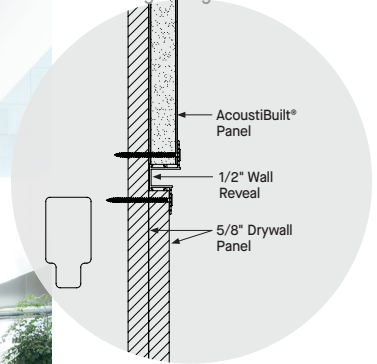

View full AcoustiBuilt® Ceiling and Walls System offering at:
armstrongceilings.com/acoustibuilt

plus capabilities
to do more



AcoustiBuilt® Seamless Acoustical Wall System

armstrongceilings.com/capabilities
See more photos at:
armstrongceilings.com/photogallery

New seamless acoustical wall system that looks like drywall, but offers acoustical performance.

KEY SELECTION ATTRIBUTES

- new** Custom colors available to meet your design palette
- new** Wall application allows for a seamless acoustical wall system (install on walls above 7 feet to prevent damage)
- Get total noise control and floor plan versatility with Total Acoustics® ceiling panel options: NRC + CAC = Total Acoustics performance
- Finished AcoustiBuilt® panels are part of the Sustain® portfolio and meet the most stringent industry sustainability compliance standards today

- Smooth non-directional, monolithic, drywall-like visual
- Add a hint of color, tailored to your design palette
- new** Use Drywall Grid SimpleSoffit™ framing system for faster, easier soffit construction
- Similar installation and finishing methods to drywall ceilings
- CleanAssure™ family of products – includes disinfectable panels, suspension systems, and trim
- Mold and mildew-resistant surface
- AcoustiBuilt® is intended for spaces desiring a Level 4 equivalent drywall finish
- Easier to install than acoustical plaster at a lower cost
- new** Improves STC of interior stud/drywall partition systems by up to 6 points*

TYPICAL APPLICATIONS

- Offices
- Lobbies
- Education
- Exposed Structure
- Retail
- Hospitality

FINE-TEXTURE FINISH FOR ACOUSTIBUILT® PANELS

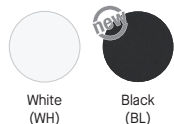

CUSTOM COLORS AVAILABLE



Available in any color!

NOTE: Custom AcoustiBuilt® fine-texture finish colors will appear 1 to 2 shades darker than a standard paint color sample when applied due to the texture in the finish.

VISUAL SELECTION

| Item No. | Dimensions (Inches) |
|--|---------------------|
| AcoustiBuilt® Wall Panels 7/8" 4-Sided Tapered Edge | 2604 48 x 72 x 7/8" |

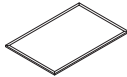

PERFORMANCE SELECTION Dots represent high level of performance (panel and grid).

| Item No. | Dimensions (Inches) | NRC | CAC | Total Acoustics ¹ | Fire Performance | Light Reflect | Anti-Mold/Mildew | Sag Resistant | Certified Low VOC Emissions | CleanAssure™ Disinfectable Panels | DURABILITY | Recycle Program | 10-Yr Warranty |
|----------|---------------------|-------|-----|------------------------------|------------------|---------------|------------------|---------------|-----------------------------|-----------------------------------|--------------------|-----------------|----------------|
| 2604 | 48 x 72 x 7/8" | 0.80* | 46 | BEST | Class A | 0.87** | | | | Fog, Spray, Wash, Scratch, Soil | N/A, N/A, N/A, N/A | | |

¹ Total Acoustics® ceiling panels have an ideal combination of sound absorption and sound blocking in one product.
* Per ASTM C423 & E795, E-400 Mounting
** White Fine-Texture Finish panel performance following the installation instructions.

STANDARD ACCESSORIES BY OTHERS – Order Separately

| Item No. | Description | Required for Install |
|--|---|----------------------|
| Screws | # 6 x 1-5/8" coarse thread drywall screws (Used for Wall Installations) | Yes |
| Setting-Type Compound | Fast-setting compound (hot mud) | Yes |
| Adhesive (Required for all ceiling and wall installations.) | Titebond® 5252 ProVantage Heavy Duty Titebond® 5262 Heavy Duty Titebond® 5342 Drywall Plus VOC Compliant Titebond® 5352 Professional Drywall Standard 189; ANSI/GBI Green Building Assessment Protocol or Equivalent | Yes |
| Drying-Type Compound | Ready-mixed lightweight compound | Yes |
| Tape | Self-adhesive mesh drywall joint tape (For Panel Joints) | Yes |
| Paper Tape | Paper drywall tape (For Corners) | Yes |

ACOUSTICAL INFORMATION

| Wall Application | Mounting Method/STC Rating*** |
|------------------|-------------------------------|
| 1 Side | 2 Sides |
| 42 | 43 |

*** 3-5/8" metal studs with one layer of 5/8" drywall on both sides and AcoustiBuilt Panels on one or both sides.

PERIMETER TRIM OPTIONS – Order Separately

| Item No. | Description | Required for Install |
|----------------------|---|----------------------|
| ARM-625500STR | 1/2" Wall reveal from 7/8" AcoustiBuilt to 5/8" Drywall | Based on layout |

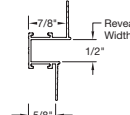

ACOUSTIBUILT FINE-TEXTURE FINISH PAINT – Order Separately

| Item No. | Description | Required for Install |
|--|---|--|
| 2605WH (White) 2605BL (Black) | Fine-Texture Finish for AcoustiBuilt® Panels (available in White, Black, and custom colors) | For every 10 panels (240 SF) - order 1 pail (4 gal.) 200 SF on custom color applications |

PHYSICAL DATA

Material
Wet-formed mineral fiber

Fire Performance
Class A: ASTM E84 and CAN/ULC S102 surface burning characteristics. Flame Spread of 25 or less. Smoke Developed of 50 or less.

ASTM E1264 Classification
Type IV, Form 2, Pattern G
Fire Class A

Humidity/Sag Resistance
HumiGuard® Plus ceiling panels are recommended for areas subject to high humidity, up to, but not including, standing water and outdoor applications.

Anti-Mold/Mildew
Finished AcoustiBuilt panels offer BioBlock® performance and resist the growth of mold and mildew on the tile surface.

High Recycled Content
Contains greater than 50% total recycled content. Total recycled content based on product composition of post-consumer and pre-consumer (post-industrial) recycled content per FTC guidelines.

VOC Emissions
GREENGUARD Gold Certified
Third-party certified compliant with California Department of Public Health CDPH/EHLB/Standard Method Version 1.2, 2017. This standard is the guideline for low emissions in LEED®, WELL Building Standard®, Living Building Challenge® (LBC), CalGreen Title 24, ANSI/ASHRAE/USGBC/IES Standard 189; ANSI/GBI Green Building Assessment Protocol

Design and Lighting Considerations
AcoustiBuilt® panels are intended for spaces desiring a Level 4 equivalent drywall finish. Like Level 4 drywall, critical or low-angle light grazing across the ceiling can show imperfections. Special attention to finishing and sanding may be required. Downlights can complement the appearance in severe grazing light.

Installation is similar to standard wallboard and drywall suspension systems. However, it requires more precision and a higher level of finish to achieve an acceptable appearance. Lighting conditions can magnify surface imperfections, especially natural light that shines from oblique angles. It is strongly recommended that a job site mockup be constructed with representative lighting so that expectations regarding the finished appearance are managed.

Lighting and diffuser fixtures must be able to accommodate 7/8" thick panels. Contact the lighting and diffuser manufacturers for recommended fixture use and integration. AcoustiBuilt® is a non-accessible ceiling. Access panels can be integrated, as needed, following standard installation practices. Refer to access panel manufacturer to verify compatibility with 7/8" thick panels.

Acoustical Considerations

PRODUCT CERTIFIED FOR LOW CHEMICAL EMISSIONS
UL.COM/GG UL 2818



When installed as a cloud, average sound absorption is 0.80 Sabins/SF. The addition of acoustical infill panel item 8200T10 can increase sound absorption up to 1.33 Sabins/SF.

Excessive integrations and/or small enclosed spaces where the ceiling is more compound than open area will result in degradation of sound absorption. Certain lighting conditions and/or colors may require an additional coat of Fine Texture Finish, resulting in a degradation of sound absorption. AcoustiBuilt® panels absorb the most sound when installed as full panels. Plan the layout to minimize panel joints and fixture integrations which cover the surface of the ceiling.

Insulation Value
R Factor – 2.2 (BTU Units)
R Factor – 0.39 (Watts Units)

Cleaning and Disinfecting
Cleaning and CDC recommended disinfecting options available on armstrongceilings.com/cleaning

10-Year Panel Warranty
Details at armstrongceilings.com/acoustibuilt

Weight; Square Feet/Carton
2604 – 1.1lbs/SF; 240 SF/ctn

Minimum Order Quantity
1 carton (10pcs)

